



Econoloc

Safety locking shroud

Econoloc gas springs eliminate the need for separate safety rods in critical lift-assist applications.

They positively lock when fully extended, protecting the operator from potential injury in the event of overload or misuse. Simple to use, they operate automatically, when the gas spring is fully extended a spring loaded locking shroud moves into place, preventing the gas spring from compressing.

The Econoloc is manually released by applying thumb pressure to the designated area of the locking shroud, allowing the gas spring to compress in a controlled manner. The locking shroud is finished with the same epoxy coating as the gas spring body, providing excellent corrosion resistance. A guide inside the shroud prevents scratching of the gas spring cylinder.

The Econoloc range of gas springs combine superior quality with the added safety feature required in many heavy duty applications, such as trucks, construction machinery, switch gear and agricultural equipment. A single Econoloc gas spring can be used in conjunction with a standard Swift & Sure version.

Benefits

- Eliminates the need for separate safety rods in critical lift-assist operations
- Operates automatically
- Safe & easy to use
- Self-contained unit
- Maintenance free
- BS EN ISO 9001 Registered Company

Pack Contents

- Parts are supplied boxed as a kitted pair comprising;
- 1 x Swift & Sure with Vari-Lift™ valve
 - 1 x Swift and Sure fitted with Econoloc shroud and Vari-Lift™ valve
 - 4 x Pre-fitted ball joint end fittings
 - 4 x Optional eye end fittings (not 14-28 models)
 - 1 x Allen key for degassing Vari-Lift™ valve
 - 1 x Instruction leaflet



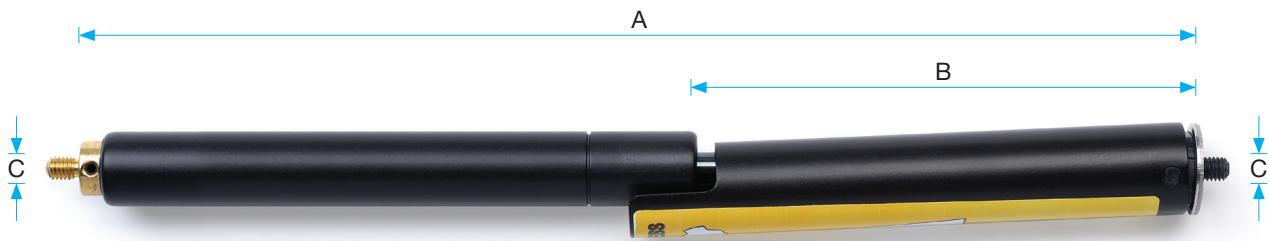

An extensive range of sizes and forces

Gas springs are commonly referred to by their size. Typically, the three sizes for Econoloc gas springs are 8-18, 10-23 and 14-28, although other sizes are available. The sizes directly relate to the diameter of the rod and the tube, for example an 8-18 will have a rod diameter of 8mm and a tube diameter of 18mm.

Econoloc

RS No.	Camloc Part No.	Econoloc Size (mm)	Max. Approx. Lift Weight (per PAIR of springs)	Extended Length Excl. End Fittings (mm) A	Stroke (mm) B	Thread Size C	Max. Force Per Spring (Newtons)	Supplied End Fit *Denotes Pre-Fitted
202-2484	SWV8ECV800001	8-18	Up to 40Kg	264	100	M6 x 1.0	650N	B2* & E3
202-2490	SWV8ECV800002			364	150			
202-2507	SWV8ECV800003			464	200			
202-2513	SWV8ECV800004			564	250			
484-7207	SWV8ECV800005			664	300			
515-2207	SWV1ECV100001	10-23	40 to 150Kg	465	200	M8 x 1.25	1200N	B4* & Z5
515-2229	SWV1ECV100002			665	300			
202-2557	SWV4ECV400001			480	200			
484-7213	SWV4ECV400002	14-28	150 to 350Kg	680	300	M10 x 1.5	2500N	B6*
202-2585	SWV4ECV400003			880	400			

End Fitting Dimensions (see table above for corresponding Econoloc)

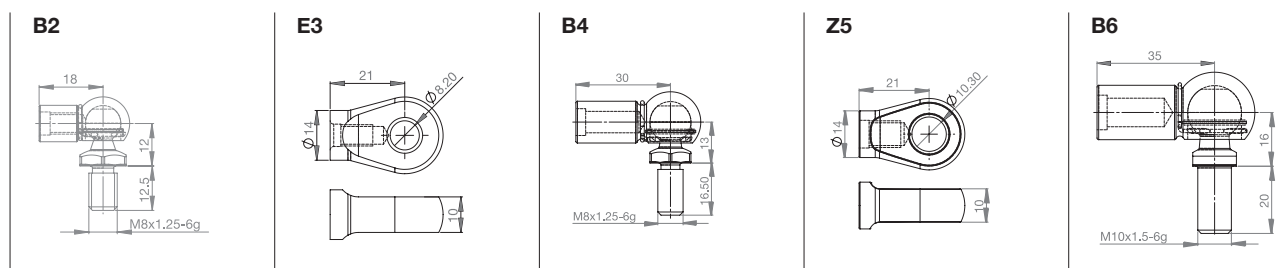

Vari-Lift™ Valve and De-gassing

Parts are supplied fitted with a Vari-Lift™ valve. The force in the gas spring is set to the maximum. Each gas spring is then de-gassed to the force required using a standard 2mm Allen key (supplied).

Fit the gas spring to the application with the rod down and brass Vari-Lift™ valve uppermost.

Using the Allen key provided, undo the Allen screw approximately ¼ of a turn until the gas can be heard escaping. Do not remove the Allen key. Tighten the Allen screw almost immediately. Do not use excessive force. Repeat on the second gas spring and try the application. Ensure that the Allen screw is fully tightened each time.

Repeat the process releasing a small amount of gas at a time until the required action is achieved.

Camloc Motion Control Ltd
 15 New Star Road, Leicester, LE4 9JD, UK
 Tel: +44 (0)116 274 3600 Fax: +44 (0)116 274 3620
 E-mail: info@camloc.com Website: www.camloc.com

Vari-Lift, Swift & Sure, Stop & Stay and Econoloc are trade names of Camloc Motion Control Ltd.

Camloc
 Gas Springs



FMS83999