

SC 4-RZ/ 6 - COMBI coupling

3042667

<https://www.phoenixcontact.com/us/products/3042667>

Please be informed that the data shown in this PDF document is generated from our online catalog. Please find the complete data in the user documentation. Our general terms of use for downloads are valid.



COMBI coupling, nom. voltage: 800 V, nominal current: 32 A, number of connections: 2, number of positions: 6, connection method: Spring-cage connection, Rated cross section: 4 mm², cross section: 0.08 mm² - 6 mm², mounting type: on mounting panel, color: gray

Your advantages

- COMBI coupling for direct mounting

Commercial data

| | |
|--------------------------------------|---------------------|
| Item number | 3042667 |
| Packing unit | 25 pc |
| Minimum order quantity | 1 pc |
| Product key | BE2145 |
| Catalog page | Page 342 (C-1-2019) |
| GTIN | 4046356012805 |
| Weight per piece (including packing) | 39.068 g |
| Weight per piece (excluding packing) | 39.068 g |
| Country of origin | PL |

SC 4-RZ/ 6 - COMBI coupling



3042667

<https://www.phoenixcontact.com/us/products/3042667>

Technical data

Product properties

| | |
|-----------------------|-------------------|
| Product type | Terminal coupling |
| Number of positions | 6 |
| Pitch | 6.2 mm |
| Number of connections | 2 |
| Number of rows | 1 |

Insulation characteristics

| | |
|----------------------|-----|
| Overvoltage category | III |
| Degree of pollution | 3 |

Electrical properties

| | |
|---|--------|
| Rated surge voltage | 8 kV |
| Maximum power dissipation for nominal condition | 1.02 W |

Connection data

| | |
|---|---|
| Nominal cross section | 4 mm ² |
| Stripping length | 8 mm ... 10 mm |
| Internal cylindrical gage | A4 |
| Connection in acc. with standard | IEC 61984 |
| Conductor cross section rigid | 0.08 mm ² ... 6 mm ² |
| Cross section AWG | 28 ... 10 (converted acc. to IEC) |
| Conductor cross section flexible | 0.08 mm ² ... 4 mm ² |
| Conductor cross section, flexible [AWG] | 28 ... 10 (converted acc. to IEC) |
| Conductor cross-section flexible (ferrule without plastic sleeve) | 0.14 mm ² ... 4 mm ² |
| Flexible conductor cross section (ferrule with plastic sleeve) | 0.14 mm ² ... 4 mm ² |
| 2 conductors with the same cross section, flexible, with TWIN ferrule with plastic sleeve | 0.5 mm ² ... 1 mm ² |
| Nominal current | 32 A |
| Maximum load current | 32 A (with 6 mm ² conductor cross section) |
| Nominal voltage | 800 V |
| Nominal cross section | 4 mm ² |

Dimensions

| | |
|--------------------|-------------------|
| Width | 37.2 mm |
| End cover width | 3.2 mm |
| Height | 31 mm |
| Drill hole spacing | 6.2 mm |
| Hole diameter | 3.5 mm |
| Pitch | 6.2 mm |
| Plate thickness | 0.8 mm ... 1.5 mm |

SC 4-RZ/ 6 - COMBI coupling



3042667

<https://www.phoenixcontact.com/us/products/3042667>

Material specifications

| | |
|---|-------------|
| Color | gray |
| Flammability rating according to UL 94 | V0 |
| Insulating material group | I |
| Insulating material | PA |
| Static insulating material application in cold | -60 °C |
| Temperature index of insulation material (DIN EN 60216-1 (VDE 0304-21)) | 130 °C |
| Relative insulation material temperature index (Elec., UL 746 B) | 130 °C |
| Fire protection for rail vehicles (DIN EN 45545-2) R22 | HL 1 - HL 3 |
| Fire protection for rail vehicles (DIN EN 45545-2) R23 | HL 1 - HL 3 |
| Fire protection for rail vehicles (DIN EN 45545-2) R24 | HL 1 - HL 3 |
| Fire protection for rail vehicles (DIN EN 45545-2) R26 | HL 1 - HL 3 |
| Calorimetric heat release NFPA 130 (ASTM E 1354) | 28 MJ/kg |
| Surface flammability NFPA 130 (ASTM E 162) | passed |
| Specific optical density of smoke NFPA 130 (ASTM E 662) | passed |
| Smoke gas toxicity NFPA 130 (SMP 800C) | passed |

Mechanical properties

Mechanical data

| | |
|-----------------|-----|
| Open side panel | Yes |
|-----------------|-----|

Technical data

| | |
|--------------------|--------|
| Drill hole spacing | 6.2 mm |
|--------------------|--------|

Environmental and real-life conditions

Ambient conditions

| | |
|--|---|
| Ambient temperature (storage/transport) | -25 °C ... 60 °C (for a short time, not exceeding 24 h, -60 °C to +70 °C) |
| Ambient temperature (assembly) | -5 °C ... 70 °C |
| Ambient temperature (actuation) | -5 °C ... 70 °C |
| Permissible humidity (storage/transport) | 30 % ... 70 % |

Standards and regulations

| | |
|----------------------------------|-----------|
| Connection in acc. with standard | IEC 61984 |
|----------------------------------|-----------|

Mounting

| | |
|---------------|-------------------|
| Mounting type | on mounting panel |
|---------------|-------------------|

SC 4-RZ/ 6 - COMBI coupling

3042667

<https://www.phoenixcontact.com/us/products/3042667>



Drawings

Diagram

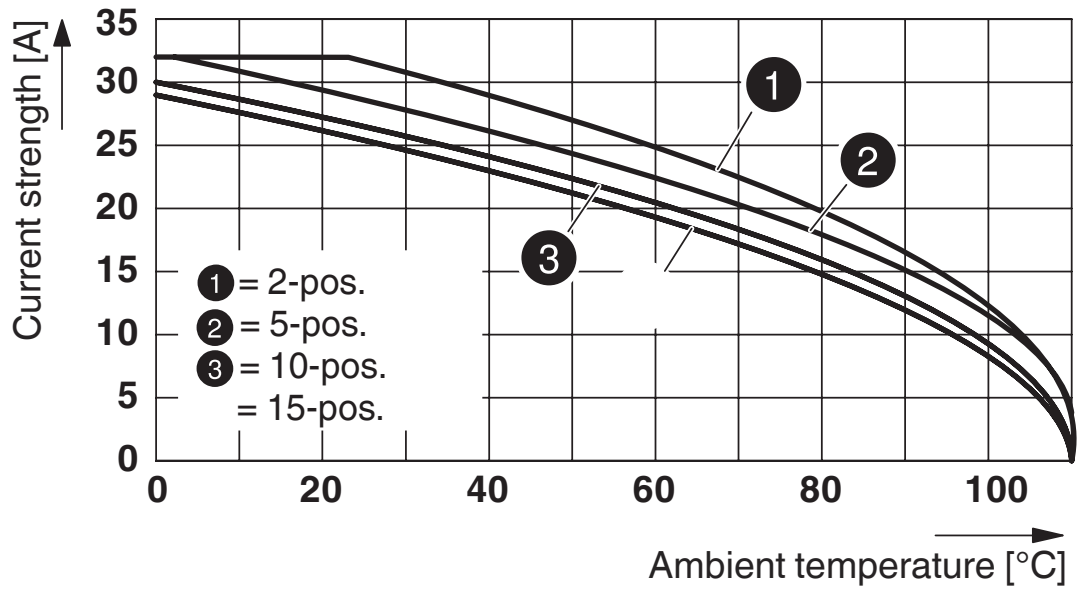

SC 4-RZ/ 6 - COMBI coupling

3042667

<https://www.phoenixcontact.com/us/products/3042667>



Drilling plan/solder pad geometry

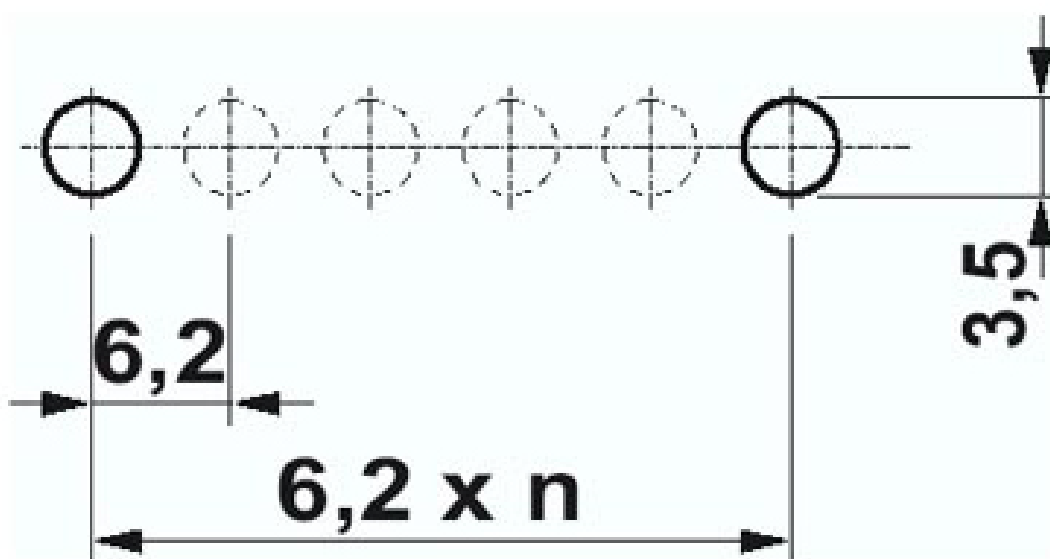

Drilling plan SC 4-RZ..., example: 1 x SC 4-RZ/ 6, metal thickness: 0.8-1.5 mm

SC 4-RZ/ 6 - COMBI coupling

3042667

<https://www.phoenixcontact.com/us/products/3042667>



Circuit diagram



SC 4-RZ/ 6 - COMBI coupling



3042667

<https://www.phoenixcontact.com/us/products/3042667>

Classifications

ECLASS

ECLASS-11.0

27141151

ETIM

ETIM 8.0

EC002021

UNSPSC

UNSPSC 21.0

39121400

SC 4-RZ/ 6 - COMBI coupling



3042667

<https://www.phoenixcontact.com/us/products/3042667>

Environmental product compliance

EU RoHS

| | |
|---|--------------------|
| Fulfills EU RoHS substance requirements | Yes, No exemptions |
|---|--------------------|

China RoHS

| | |
|--|--|
| Environment friendly use period (EFUP) | EFUP-E |
| | No hazardous substances above the limits |

EU REACH SVHC

| | |
|-------------------------------------|----------------------------|
| REACH candidate substance (CAS No.) | No substance above 0.1 wt% |
|-------------------------------------|----------------------------|

SC 4-RZ/ 6 - COMBI coupling

3042667

<https://www.phoenixcontact.com/us/products/3042667>



Accessories

D-SC 4 - End cover

3043307

<https://www.phoenixcontact.com/us/products/3043307>

End cover, depth: 48.6 mm, width: 3.2 mm, height: 22.3 mm, color: gray



CZ/2 - Strain relief

3043831

<https://www.phoenixcontact.com/us/products/3043831>

Strain relief, width: 19.8 mm, height: 28.9 mm, number of positions: 2, color: black



SC 4-RZ/ 6 - COMBI coupling

3042667

<https://www.phoenixcontact.com/us/products/3042667>



SZF 1-0,6X3,5 - Screwdriver

1204517

<https://www.phoenixcontact.com/us/products/1204517>



Actuation tool, for ST terminal blocks, also suitable for use as a bladed screwdriver, size: 0.6 x 3.5 x 100 mm, 2-component grip, with non-slip grip

ST-BW - Actuation tool

1207608

<https://www.phoenixcontact.com/us/products/1207608>



Actuation tool, for all 2.5 mm² - 4.0 mm² spring-cages

SC 4-RZ/ 6 - COMBI coupling

3042667

<https://www.phoenixcontact.com/us/products/3042667>



PC - Coding star

3040588

<https://www.phoenixcontact.com/us/products/3040588>



Coding star, 4-section, depth: 6 mm, width: 3 mm, height: 3 mm, color: red

MPS-MT - Test plug

0201744

<https://www.phoenixcontact.com/us/products/0201744>



Test plug, with solder connection up to 1 mm² conductor cross section, number of positions: 1, color: gray

SC 4-RZ/ 6 - COMBI coupling

3042667

<https://www.phoenixcontact.com/us/products/3042667>



MPS-IH WH - Insulating sleeve

0201663

<https://www.phoenixcontact.com/us/products/0201663>

Insulating sleeve, color: white



MPS-IH RD - Insulating sleeve

0201676

<https://www.phoenixcontact.com/us/products/0201676>

Insulating sleeve, color: red



SC 4-RZ/ 6 - COMBI coupling

3042667

<https://www.phoenixcontact.com/us/products/3042667>



MPS-IH BU - Insulating sleeve

0201689

<https://www.phoenixcontact.com/us/products/0201689>

Insulating sleeve, color: blue

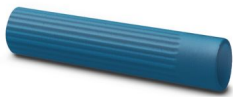

MPS-IH YE - Insulating sleeve

0201692

<https://www.phoenixcontact.com/us/products/0201692>

Insulating sleeve, color: yellow



SC 4-RZ/ 6 - COMBI coupling

3042667

<https://www.phoenixcontact.com/us/products/3042667>



MPS-IH GN - Insulating sleeve

0201702

<https://www.phoenixcontact.com/us/products/0201702>

Insulating sleeve, color: green



MPS-IH GY - Insulating sleeve

0201728

<https://www.phoenixcontact.com/us/products/0201728>

Insulating sleeve, color: gray



SC 4-RZ/ 6 - COMBI coupling

3042667

<https://www.phoenixcontact.com/us/products/3042667>



MPS-IH BK - Insulating sleeve

0201731

<https://www.phoenixcontact.com/us/products/0201731>

Insulating sleeve, color: black



ISH 4/0,5 - Insulating sleeve

3002885

<https://www.phoenixcontact.com/us/products/3002885>

Insulating sleeve, color: gray



SC 4-RZ/ 6 - COMBI coupling

3042667

<https://www.phoenixcontact.com/us/products/3042667>



ISH 4/1,0 - Insulating sleeve

3002898

<https://www.phoenixcontact.com/us/products/3002898>



Insulating sleeve, color: black

Phoenix Contact 2024 © - all rights reserved

<https://www.phoenixcontact.com>

Phoenix Contact USA
586 Fulling Mill Road
Middletown, PA 17057, United States
(+717) 944-1300
info@phoenixcon.com