

DWR Sectional Wall Mount Rack

Redesigned Sectional Wall Mount Rack with Enhanced Cable Management for Larger Systems



- ? UL Listed in the US and Canada
- ? Tool-Free QuickMount™ system allows for easy, one-person mounting of the center section to the backpan on the jobsite
- ? Available in 15, 20", 24" and **NEW** 30" useable depths
- ? Welded construction provides up to a 300 lb. weight capacity, depending on model
- ? Abundant built-in cable lacing points in interior
- ? 1/2", 3/4", 1", 1 1/2", 2" and 3" electrical knockouts and 5/8" JHF/VHF antenna knockouts on top & bottom, easily removable for cable passage
- ? 12 1/2" x 12 1/2" laser knockout opening in the backpan for electrical back
- ? Abundant Velcro and internal cable tie points
- ? Finished in a durable black or granite gray textured powder coat
- ? Standard adjustable front 1 1/2" gauge 1032 threaded rackrail with marked rackspace increments to speed equipment mounting
- ? Center section hinges for left or right opening accessories
- ? 2" knockouts, 4" knockouts for Wiremold 4000 Series raceways, and knockouts for UCP series universal connector panels on side
- ? Grounding/bonding stud in top and bottom of center section and backpan facilitate proper grounding and bonding of electronic equipment, as per NEBS and NEC standards
- ? Front Mounted **Zero Clearance Latch** saves valuable wall space by allowing wall racks to be placed side-by-side, in a corner, or wherever side clearance is an issue
- ? Backpan includes raised mounting embosses to mount power and other accessories



[click to enlarge](#)

Enclosure Options

- ? [vertical AC power strips](#)
- ? [PDT thin power strips - NEW](#)
- ? [cable lacing bars](#)
- ? [equip. mounting hdwr.](#)
- ? [fans and guards](#)
- ? [vent blockers](#)
- ? [additional rackrail](#)
- ? [doors](#)
- ? [zero clearance latch](#)



Click [HERE](#) to Download the **Thermal Management White Paper**

All of our rackrail is finished in durable 'e-coat' to guarantee no clogged threads. [click for more](#)



#96-045 [Download or view PDF file](#)

Tool-Free QuickMount™ click [HERE](#) for video demonstration (2.4MB)



Optional cover plate/shelf kit. Model #



Fan kits include two 4 1/2" exhaust fans, fan guards and vent blockers. Model # **DWR - FK17** (fits 17" depth), **DWR - FK22** (22" depth), **DWR - FK26** (26" depth), or **DWR - FK32** (fits 32" depth)

DWR - CVR

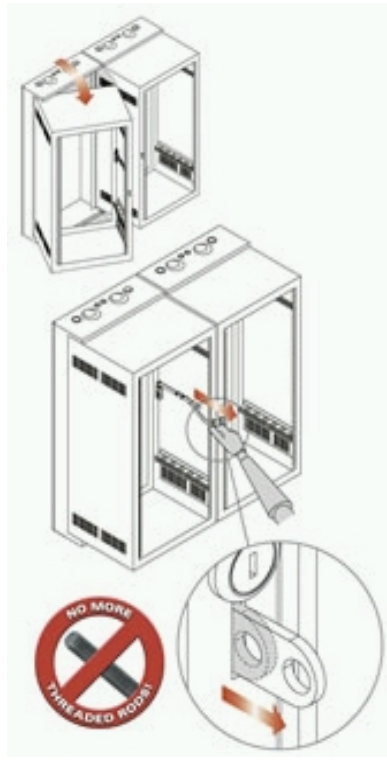

[Click here to see our new Zero Clearance Latch option](#)

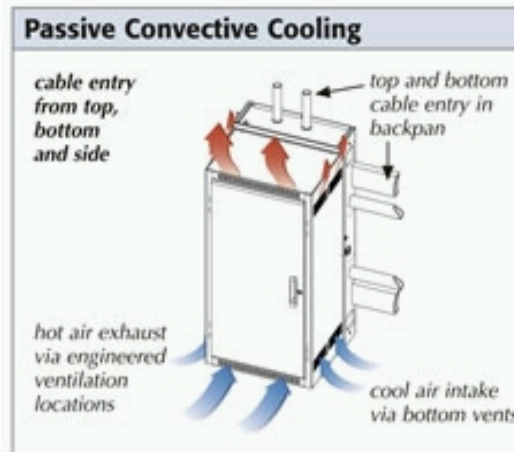
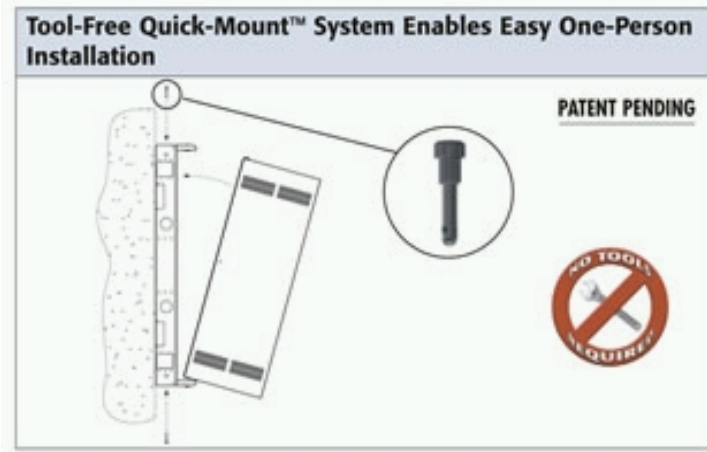

17" Deep (15" Useable) Part #**	22" Deep (20" Useable) Part #**	26" Deep (24" Useable) Part #**	NEW! 32" Deep (30" Useable) Part #**	Fully Assembled with Plexi Front Door			Racking Height	Weight Capacity	Overall Height	Power Strip*
				17" Deep (15" Useable) Part #**	22" Deep (20" Useable) Part #**	26" Deep (24" Useable) Part #**				
DWR-35-17	DWR-35-22	DWR-35-26	-	-	DWR-35-22PD	DWR-35-26PD	61 1/4" (35 space)	300 lbs.	68 5/16"	G J N C **
DWR-24-17	DWR-24-22	DWR-24-26	DWR-24-32	DWR-24-17PD	DWR-24-22PD	DWR-24-26PD	42" (24 space)	300 lbs.	49 1/16"	E G J C **
DWR-21-17	DWR-21-22	-	-	DWR-21-17PD	DWR-21-22PD	-	36 3/4" (21 space)	250 lbs.	43 13/16"	E G C **
DWR-18-17	DWR-18-22	DWR-18-26	DWR-18-32	-	-	DWR-18-26PD	31 1/2" (18 space)	250 lbs.	38 9/16"	E C **
DWR-16-17	DWR-16-22	-	-	DWR-16-17PD	DWR-16-22PD	-	28" (16 space)	200 lbs.	35 1/16"	C **
DWR-12-17	DWR-12-22	DWR-12-26	DWR-12-32	-	-	DWR-12-26PD	21" (12 space)	200 lbs.	28 1/16"	C **
DWR-10-17	DWR-10-22	-	-	DWR-10-17PD	DWR-10-22PD	-	17 1/2" (10 space)	200 lbs.	24 9/16"	C **

* Accommodates vertical power strips

**Mounts in backpan only, does not require PBWR

NOTE: When mounting vertical power strips in DWR center section, [PBWR](#) is required.

NOTE: To order with granite gray finish, suffix part #'s with GY.

Part #	Solid Front Door	Plexi Front Door	25% Open Area Front Door	64% Open Area Front Door	Add'l 1032 Threaded Rackrail
DWR-35-17/22/26	FD-35	PFD-35	VFD-35	LVFD-35	DWR-RR35
DWR-24-17/22/26	FD-24	PFD-24	VFD-24	LVFD-24	DWR-RR24
DWR-21-17/22	FD-21	PFD-21	VFD-21	LVFD-21	DWR-RR21
DWR-18-17/22/26	FD-18	PFD-18	VFD-18	LVFD-18	DWR-RR18
DWR-16-17/22	FD-16	PFD-16	VFD-16	LVFD-16	DWR-RR16
DWR-12-17/22/26	FD-12	PFD-12	VFD-12	LVFD-12	DWR-RR12
DWR-10-17/22	FD-10	PFD-10	VFD-10	LVFD-10	DWR-RR10

NOTE: To order with granite gray finish, suffix part #'s with GY.