

## 29.91.11

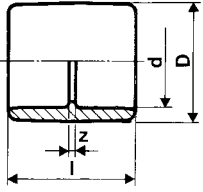
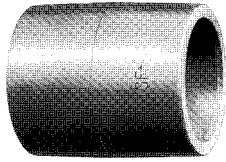

## Socket

| d       | PN | Code        | £ | SP | GP | g    | z  | D   | l   |
|---------|----|-------------|---|----|----|------|----|-----|-----|
| 3/8     | 15 | 729.911.105 |   |    |    | 7    | 3  | 23  | 35  |
| 1/2     | 15 | 729.911.106 |   |    |    | 7    | 3  | 27  | 38  |
| 3/4     | 15 | 729.911.107 |   |    |    | 12   | 3  | 33  | 45  |
| 1       | 15 | 729.911.108 |   |    |    | 20   | 3  | 41  | 51  |
| 1 1/4   | 15 | 729.911.109 |   |    |    | 35   | 3  | 51  | 60  |
| 1 1/2   | 15 | 729.911.110 |   |    |    | 46   | 3  | 58  | 64  |
| 2       | 15 | 729.911.111 |   |    |    | 86   | 5  | 72  | 78  |
| 2 1/2** | 15 | 729.910.112 |   |    |    | 286  | 8  | 93  | 95  |
| 3       | 15 | 729.911.113 |   |    |    | 240  | 7  | 104 | 108 |
| 4       | 15 | 729.911.115 |   |    |    | 494  | 8  | 134 | 135 |
| 6*      | 15 | 729.911.117 |   |    |    | 1470 | 11 | 197 | 192 |
| 8**     | 15 | 729.911.120 |   |    |    | 2870 | 10 | 253 | 248 |

\*Maximum working pressure for size 6 inch: 12 bar (173 lbf/in<sup>2</sup>) at 20°C.

\*\*Maximum working pressure for size 2 1/2 & 8 inch: 9 bar (130 lbf/in<sup>2</sup>) at 20°C.

## 29.90.13

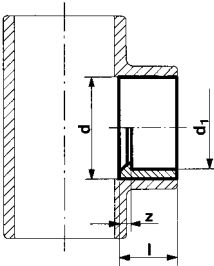

## Reducing Bush (Short Pattern)

| d             | PN | Code        | £ | SP | GP | g    | z  | l   |
|---------------|----|-------------|---|----|----|------|----|-----|
| 1/2 x 3/8     | 15 | 729.901.334 |   |    |    | 3    | 2  | 18  |
| 3/4 x 1/2     | 15 | 729.901.337 |   |    |    | 4    | 3  | 21  |
| 1 x 1/2       | 15 | 729.901.342 |   |    |    | 10   | 6  | 24  |
| 1 x 3/4       | 15 | 729.901.341 |   |    |    | 8    | 3  | 24  |
| 1 1/4 x 1     | 15 | 729.901.346 |   |    |    | 12   | 5  | 29  |
| 1 1/2 x 1     | 15 | 729.901.353 |   |    |    | 26   | 6  | 30  |
| 1 1/2 x 1 1/4 | 15 | 729.901.352 |   |    |    | 10   | 2  | 30  |
| 2 x 1         | 15 | 729.901.360 |   |    |    | 44   | 13 | 37  |
| 2 x 1 1/2     | 15 | 729.901.358 |   |    |    | 36   | 6  | 37  |
| 4 x 3         | 15 | 729.901.381 |   |    |    | 238  | 13 | 64  |
| 8 x 6*        | 15 | 729.901.396 |   |    |    | 1260 | 33 | 119 |

\*Maximum working pressure for size 8 inch: 9 bar (130 lbf/in<sup>2</sup>) at 20°C.

## 29.91.13

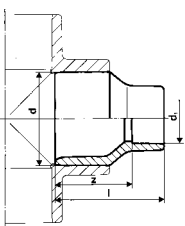

## Reducing Bush (Long Pattern)

| d     | PN | Code        | £ | SP | GP | g   | z   | l   |
|-------|----|-------------|---|----|----|-----|-----|-----|
| 3 x 1 | 15 | 729.911.374 |   |    |    | 120 | 73  | 97  |
| 3 x 2 | 15 | 729.911.371 |   |    |    | 195 | 73  | 110 |
| 6 x 4 | 15 | 729.911.389 |   |    |    | 955 | 133 | 197 |

## 29.96.11

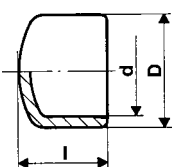

## Cap 29.96.11

| d     | PN | Code        | £ | SP | GP | g   | D   | l   |
|-------|----|-------------|---|----|----|-----|-----|-----|
| 3/8   | 15 | 729.961.105 |   | 10 |    | 5   | 26  | 23  |
| 1/2   | 15 | 729.961.106 |   | 10 |    | 6   | 30  | 25  |
| 3/4   | 15 | 729.961.107 |   | 10 |    | 10  | 37  | 30  |
| 1     | 15 | 729.961.108 |   | 10 |    | 18  | 44  | 34  |
| 1 1/4 | 15 | 729.961.109 |   | 10 |    | 30  | 55  | 41  |
| 1 1/2 | 15 | 729.961.110 |   | 10 |    | 39  | 62  | 44  |
| 2     | 15 | 729.961.111 |   | 5  |    | 77  | 78  | 54  |
| 3     | 15 | 729.961.113 |   | 1  |    | 217 | 112 | 77  |
| 4     | 15 | 729.961.115 |   | 1  |    | 560 | 145 | 101 |