

# Micro-D Dust Caps and Interfacial Seals

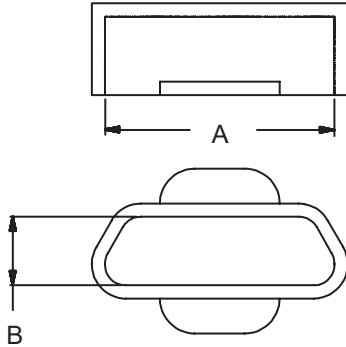

MIL-DTL-83513  
Micro-D

## MOLDED PLASTIC DUST CAPS



Anti-static Micro-D dust caps are available to fit all sizes of Metal Shell Micro-D connectors. These dust caps are injection-molded from a rugged plastic material that resists cracking and provides protection.

Material: Polypropylene, anti-static, color black.

Layout	Part Number	A Ref.	B Ref.
9P	000-01-09-162	.315 (8.0)	.184 (4.7)
9S	000-01-09-163	.385 (9.8)	.250 (6.4)
15P	000-01-15-162	.465 (11.8)	.184 (4.7)
15S	000-01-15-163	.535 (13.6)	.250 (6.4)
21P	000-01-21-162	.615 (15.6)	.184 (4.7)
21S	000-01-21-163	.685 (17.4)	.250 (6.4)
25P	000-01-25-162	.715 (18.2)	.184 (4.7)
25S	000-01-25-163	.785 (19.9)	.250 (6.4)
31P	000-01-31-162	.865 (22.0)	.184 (4.7)
31S	000-01-31-163	.935 (23.7)	.250 (6.4)
37P	000-01-37-162	1.015 (25.8)	.184 (4.7)
37S	000-01-37-163	1.085 (27.6)	.250 (6.4)
51P	000-01-51-162	.965 (24.5)	.227 (5.8)
51S	000-01-51-163	1.035 (26.3)	.292 (7.4)
100P	000-01-00-162	1.364 (34.6)	.270 (6.9)
100S	000-01-00-163	1.437 (36.5)	.338 (8.6)

## MICRO-D INTERFACIAL SEALS FOR MWDM SOCKET CONNECTORS

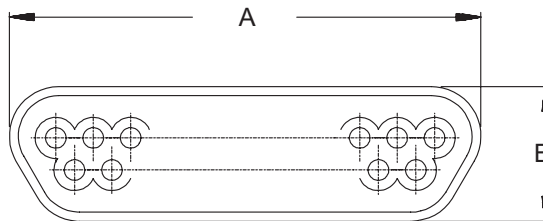

Micro-D interfacial seals are available for metal shell socket connectors. Intended for use as field replacements for damaged seals, these seals are molded from fluorosilicone elastomer and meet NASA outgassing requirements.

Material: Blue fluorosilicone per ZZ-R-765.

Layout	Part Number	A Ref.	B Ref.
9S	000-01-09-132	.330 (8.4)	.180 (4.6)
15S	000-01-15-132	.480 (12.2)	.180 (4.6)
21S	000-01-21-132	.630 (16.0)	.180 (4.6)
25S	000-01-25-132	.730 (18.5)	.180 (4.6)
31S	000-01-31-132	.880 (22.4)	.180 (4.6)
37S	000-01-37-132	1.030 (26.2)	.180 (4.6)
51S	000-01-51-132	.976 (24.8)	.223 (5.7)
100S	000-01-00-132	1.386 (35.2)	.270 (6.9)

Metric dimensions (mm) are indicated in parentheses.

# Mouser Electronics

Authorized Distributor

Click to View Pricing, Inventory, Delivery & Lifecycle Information:

## Glenair:

[000-01-00-163](#) [000-01-00-162](#) [000-01-51-163](#) [000-01-25-163](#) [000-01-00-132](#) [000-01-09-132](#) [000-01-09-164](#) [000-01-09-165](#) [000-01-15-132](#) [000-01-15-164](#) [000-01-15-165](#) [000-01-21-132](#) [000-01-21-162](#) [000-01-21-163](#) [000-01-21-164](#) [000-01-21-165](#) [000-01-25-132](#) [000-01-25-164](#) [000-01-25-165](#) [000-01-31-132](#) [000-01-31-163](#) [000-01-31-164](#) [000-01-31-165](#) [000-01-37-132](#) [000-01-37-164](#) [000-01-37-165](#) [000-01-51-132](#) [000-01-51-164](#) [000-01-51-165](#) [000-01-15-163](#) [000-01-09-162](#) [000-01-15-162](#) [000-01-25-162](#) [000-01-31-162](#) [000-01-51-162](#) [000-01-37-162](#) [000-01-09-163](#) [000-01-37-163](#)