

- NOTES:
1. MATERIAL: SEE TABLE
 2. FINISHES: SEE TABLE
 3. ELECTRICAL SPECIFICATIONS
VOLTAGE RATING: 300V AC/DC
CURRENT RATING: 15 AMPS (BINDING HD SCREW)
CURRENT RATING: 25 AMPS (WIRE CLAMP SCREW -50 OPT)
 4. WIRE RANGE: 14-22 AWG FOR BINDING HD., 12-22 AWG FOR -50 OPT
 5. SCREW TIGHTENING TORQUE: 12 IN LBS.
 6. WIRE STRIP: 7.9mm (.31 IN)
 7. OPERATING TEMP: -40°C TO +130°C (B1)
 8. PRODUCT SPEC: PS-38710-001
 9. XX REFERS TO NUMBER OF CIRCUITS

ITEM	QTY.	DESCRIPTION	MATERIAL	FINISH
6	XX	#6-32 PHSL SCR BHD SS (-56 OPTION)	ST. STEEL	PASSIVATED
5	XX	#6-32 PHSL SCR W/WSHR (-50 OPTION)	STEEL	ZINC PLATED
4	XX	#6-32 BHD PHIL-SLOTTED SCREW (-49 OPTION)	BRASS	NICKEL PLATED
3	XX	#6-32 SCREW PHIL.-SLOTTED (STANDARD)	STEEL	ZINC PLATED
2	2	TERMINAL	BRASS	TIN PLATED
1	1	BARRIER	PBT	BLACK

TOLERANCES			
MM	TOL	INCH	TOL
0-6	±0.25	0-.24	±.010
>6-30	±0.40	>.24-1.18	±.016
>30-120	±0.50	>1.18-4.76	±.020
>120	±0.80	>4.76	±.031

THIS DRAWING CONTAINS INFORMATION THAT IS PROPRIETARY TO MOLEX ELECTRONIC TECHNOLOGIES, LLC AND SHOULD NOT BE USED WITHOUT WRITTEN PERMISSION

molex

9.53MM [.375] SR BTS
PC ASSY, NO MTG

PRODUCT CUSTOMER DRAWING

DOCUMENT NUMBER: SD-38720-002 | DOC TYPE: PSD | DOC PART: 001 | REVISION: B1

SHEET NUMBER: 1 OF 2

EC NO: 773853 | DRWN: ABENJAMINLW | 2022/05/20 | 2024/01/10
CHKD: DACHAMMER | APPR: JFMURPHY | 2024/01/11
INITIAL REVISION: DRWN: SBULLERWELL | 2003/11/14 | 2003/11/17
APPR: pwaltz

FUNCTIONAL SYMBOLS: FA=0, FE=0, FE=0

DIVISIONAL SYMBOLS: 4 PLACES, 3 PLACES, 2 PLACES, 1 PLACE, 0 PLACES

ANGULAR TOL: ± ---

DRAFT WHERE APPLICABLE MUST REMAIN WITHIN DIMENSIONS

THIRD ANGLE PROJECTION

SCALE: 2:1

GENERAL TOLERANCES (UNLESS SPECIFIED): 4 PLACES, 3 PLACES, 2 PLACES, 1 PLACE, 0 PLACES

MM/INCH

SCALE: 2:1

CURRENT REV DESC: MIGRATED TO NX. REMOVED SCREW OPT -47 AND -50-92. ADDED SCREW OPT -56. REMOVED OBOSOLETED PNS

DRWG: B-SIZE | SERIES: 38720 | MATERIAL NUMBER: SEE SHEET-2 | CUSTOMER: GENERAL MARKET

NO. OF CIRCUITS "XX"	DIM. "A"		DIM. "B"		ASSEMBLY MATERIAL NO. (OPT -C)	ASSEMBLY MATERIAL NO. (OPT -C, -49)	ASSEMBLY MATERIAL NO. (OPT -C, -50)	ASSEMBLY MATERIAL NO. (OPT -C, -56)
	MM	IN	MM	IN				
02	21.1	[.83]	9.53	[.375]	387206302	387206902	387207502	387290674
03	30.7	[1.21]	19.05	[.750]	387206303	387206903	387207503	387290032
04	40.1	[1.58]	28.58	[1.125]	387206304	387206904	387207504	
05	49.8	[1.96]	38.10	[1.500]	387206305	387206905	387207505	387291454
06	59.2	[2.33]	47.63	[1.875]	387206306	387206906	387207506	---
07	68.8	[2.71]	57.15	[2.250]	387206307	387206907	387207507	387290462
08	78.3	[3.08]	66.68	[2.625]	387206308	387206908	387207508	387291271
09	87.8	[3.46]	76.20	[3.000]	387206309	387206909	387207509	387290573
10	97.3	[3.83]	85.73	[3.375]	387206310	387206910	387207510	387290584
11	106.9	[4.21]	95.25	[3.750]	387206311	387206911	387207511	
12	116.3	[4.58]	104.78	[4.125]	387206312	387206912	387207512	387290800
13	126.0	[4.96]	114.30	[4.500]	387206313	387206913	387207513	
14	135.3	[5.33]	123.83	[4.875]	387206314	387206914	387207514	
15	145.0	[5.71]	133.35	[5.250]	387206315	387206915	387207515	
16	154.4	[6.08]	142.88	[5.625]	387206316	387206916	387207516	
17	164.1	[6.46]	152.40	[6.000]	---	---	---	
18	173.5	[6.83]	161.93	[6.375]	387206318	387206918	387207518	
19	183.1	[7.21]	171.45	[6.750]	387206319	387206919	387207519	387290681
20	192.5	[7.58]	180.98	[7.125]	387206320	387206920	387207520	387290685
21	202.2	[7.96]	190.50	[7.500]	387206321	387206921	387207521	
22	211.6	[8.33]	200.03	[7.875]	387206322	387206922	387207522	
23	221.6	[8.71]	209.55	[8.250]	387206323	387206923	387207523	
24	230.6	[9.08]	219.08	[8.625]	387206324	387206924	387207524	
25	240.3	[9.46]	228.60	[9.000]	387206325	387206925	387207525	
26	249.6	[9.83]	238.13	[9.375]	387206326	387206926	387207526	

B1

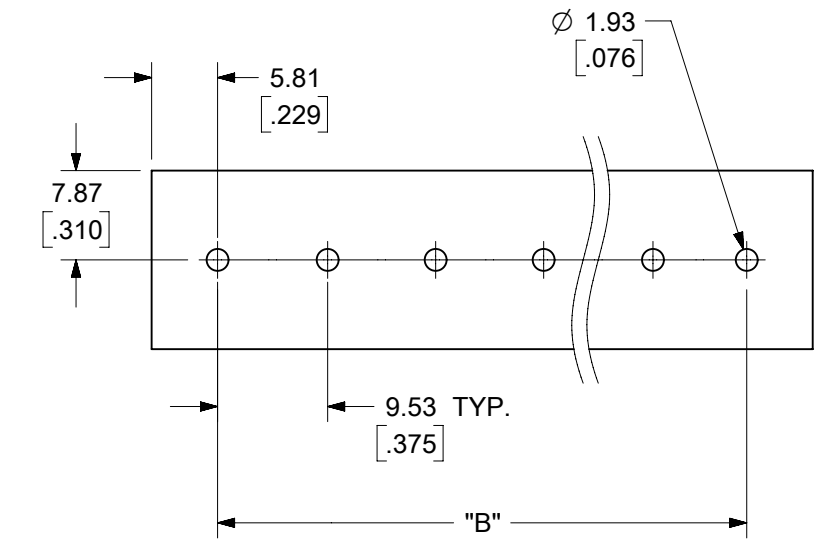

PTH PATTERN (SCALE 1.5:1)

TOLERANCES			
MM	TOL	INCH	TOL
0-6	±0.25	0-.24	±.010
>6-30	±0.40	>.24-1.18	±.016
>30-120	±0.50	>1.18-4.76	±.020
>120	±0.80	>4.76	±.031

FUNCTIONAL SYMBOLS FA = 0 FE = 0 FE = 0	THIS DRAWING CONTAINS INFORMATION THAT IS PROPRIETARY TO MOLEX ELECTRONIC TECHNOLOGIES, LLC AND SHOULD NOT BE USED WITHOUT WRITTEN PERMISSION																				
	DIMENSION UNITS MM/INCH	SCALE 1:1			CURRENT REV DESC: MIGRATED TO NX. REMOVED SCREW OPT -47 AND -50-92. ADDED SCREW OPT -56. REMOVED OBOSOLETED PNS																
DIVISIONAL SYMBOLS	GENERAL TOLERANCES (UNLESS SPECIFIED)		EC NO: 773853 DRWN: ABENJAMINLW 2022/05/20 CHKD: DACHAMMER 2024/01/10 APPR: JFMURPHY 2024/01/11																		
	<table border="1"> <thead> <tr> <th></th> <th>MM</th> <th>INCH</th> </tr> </thead> <tbody> <tr> <td>4 PLACES</td> <td>± ---</td> <td>± ---</td> </tr> <tr> <td>3 PLACES</td> <td>± ---</td> <td>± SEE CHART</td> </tr> <tr> <td>2 PLACES</td> <td>± SEE CHART</td> <td>± SEE CHART</td> </tr> <tr> <td>1 PLACE</td> <td>± SEE CHART</td> <td>± ---</td> </tr> <tr> <td>0 PLACES</td> <td>± ---</td> <td>± ---</td> </tr> </tbody> </table>			MM	INCH	4 PLACES	± ---	± ---	3 PLACES	± ---	± SEE CHART	2 PLACES	± SEE CHART	± SEE CHART	1 PLACE	± SEE CHART	± ---	0 PLACES	± ---	± ---	INITIAL REVISION: DRWN: SBULLERWELL 2003/11/14 APPR: pwaltz 2003/11/17
	MM	INCH																			
4 PLACES	± ---	± ---																			
3 PLACES	± ---	± SEE CHART																			
2 PLACES	± SEE CHART	± SEE CHART																			
1 PLACE	± SEE CHART	± ---																			
0 PLACES	± ---	± ---																			
DRAFT WHERE APPLICABLE MUST REMAIN WITHIN DIMENSIONS		THIRD ANGLE PROJECTION	DRAWING B-SIZE	SERIES 38720																	
DOCUMENT STATUS P1		RELEASE DATE 2024/01/11 17:01:58	PRODUCT CUSTOMER DRAWING DOCUMENT NUMBER: SD-38720-002 DOC TYPE: PSD DOC PART: 001 REVISION: B1																		
			MATERIAL NUMBER SEE CHART	CUSTOMER GENERAL MARKET																	
			SHEET NUMBER 2 OF 2																		