

16

1636 05

Power supply connectors



Power supply plug acc. to JEITA RC-5320A JSBP5, straight version, with solder eyes and bend protection

16

1636 05

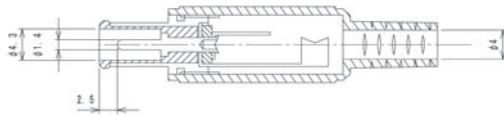
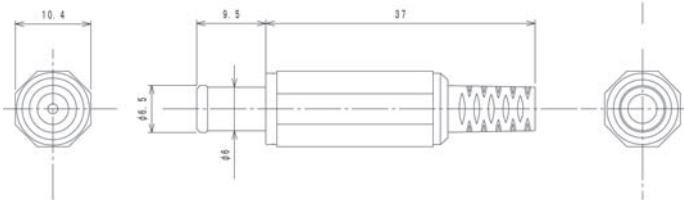

#### Environmental conditions

Temperature range -20 °C/+70 °C

#### Materials

Insulating body	PF, HB according to UL94
Contact	CuZn, nickel-plated
Lötkontakt	steel, pre-copper and nickel-plated
Insulation	POM, HB according to UL94
Housing	PE

#### Mechanical data

Outer diameter	6.5 mm
Inner diameter	4.3 mm
Diameter center pin	1.4 mm

#### Connectable conductors for solder area

Cable diameter 4 mm

#### Electrical data (at T<sub>amb</sub> 20 °C)

Rated current	2 A
Rated voltage	18 V DC
Rated impulse voltage	500 V/60 s
Insulation resistance	≥ 100 MΩ

#### Associated products

Counterparts  
[↗ 1613 11](#)      [↗ 1614 05](#)

16

1636 05

Designation	Pole Number	PU (Pieces)	MDQ (Pieces)
1636 05	2	100	500

**Packaging:**

in bulk, in a cardboard box or a plastic bag