

**SAMZO REAC/ROHS**

REV	ECN NO	DESCRIPTION	DESIGN	APPROVAL	DATE
A1	NEW	Replace frame			2019.02.27

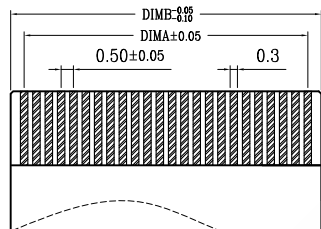
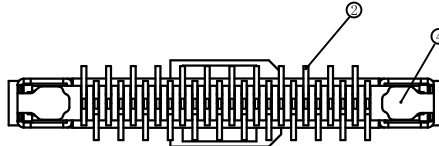
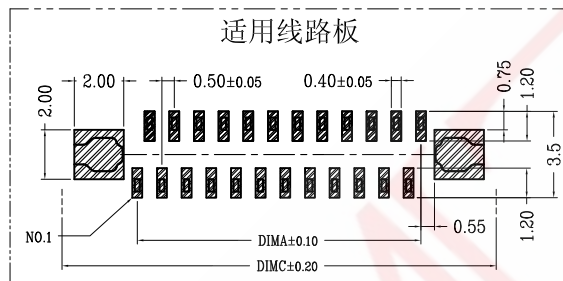
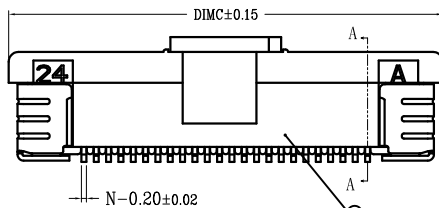
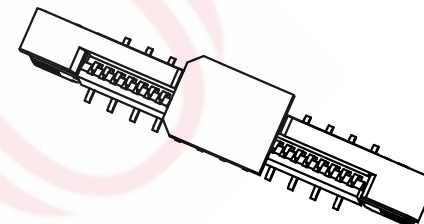
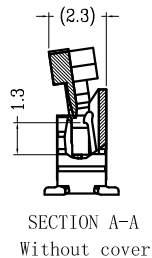
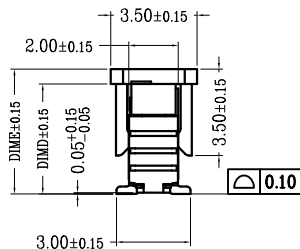
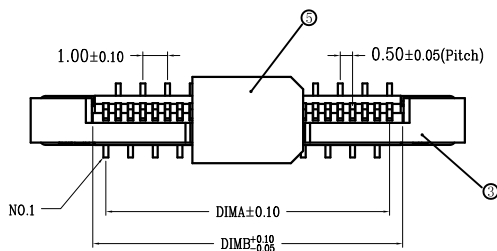

Performance:  
 Rated voltage: 50V AC/DC (equivalent)  
 Contact resistance: ≤ 0.03 Ω  
 Insulation resistance: 500 MΩ  
 Operating temperature: -25°C to 85°C

**5C 3 H F 20 \*\***

- Series: 5C-FPC
- Pitch: 3-0.5mm
- Mounting method: H - Vertical mounting, positive pin position
- Access method: F - Drawer type
- Main body thickness: 20 - 2.0mm
- PIN NO: 04 - 60PIN

CKT	DIM A	DIM E	DIM C	DIM D	DIM E
4	1.50	2.56	7.30		
5	2.00	3.06	8.10		
6	2.50	3.56	8.30		
7	3.00	4.06	9.10		
8	3.50	4.56	9.60		
9	4.00	5.06	10.10		
10	4.50	5.56	10.60		
11	5.00	6.06	11.10		
12	5.50	6.56	11.60		
13	6.00	7.06	12.10		
14	6.50	7.56	12.60		
15	7.00	8.06	13.10		
16	7.50	8.56	13.60		
17	8.00	9.06	14.10		
18	8.50	9.56	14.60		
19	9.00	10.06	15.10	4.45	5.05
20	9.50	10.56	15.60		
21	10.00	11.06	16.10		
22	10.50	11.56	16.60		
23	11.00	12.06	17.10		
24	11.50	12.56	17.60		
25	12.00	13.06	18.10		
26	12.50	13.56	18.60		
27	13.00	14.06	19.10		
28	13.50	14.56	19.60		
29	14.00	15.06	20.10		
30	14.50	15.56	20.60		
31	15.00	16.06	21.10		
32	15.50	16.56	21.60		
33	16.00	17.06	22.10		
34	16.50	17.56	22.60		

CKT	DIM A	DIM B	DIM C	DIM D	DIM E
35	17.00	18.06	23.10		
36	17.50	18.56	23.60		
37	18.00	19.06	24.10		
38	18.50	19.56	24.60		
39	19.00	20.06	25.10		
40	19.50	20.56	25.60		
41	20.00	21.06	26.10		
42	20.50	21.56	26.60		
43	21.00	22.06	27.10		
44	21.50	22.56	27.60		
45	22.00	23.06	28.10		
46	22.50	23.56	28.60		
47	23.00	24.06	29.10	5.00	5.60
48	23.50	24.56	29.60		
49	24.00	25.06	30.10		
50	24.50	25.56	30.60		
51	25.00	26.06	31.10		
52	25.50	26.56	31.60		
53	26.00	27.06	32.10		
54	26.50	27.56	32.60		
55	27.00	28.06	33.10		
56	27.50	28.56	33.60		
57	28.00	29.06	34.10		
58	28.50	29.56	34.60		
59	29.00	30.06	35.10		
60	29.50	30.56	35.60		

ITEM	DESCRIPTION	MATERIAL	QTY	FINISH/COLOR					
5	吸盖	LCP	1	黑色	GENERAL TOLERANCE				
4	焊片	磷铜	2	镀锡	DESIGN	WANGGUIFA	2018.06.12	≥2~5<	±0.25
3	后盖	LCP	1	黑色	CHECKED	ZHENGUILAN	2018.06.12	≥0~2<	±0.15
2	端子	磷青铜	N	镀锡	APPROVED	LILIANJIANG	2018.06.14	≥5	±0.35
1	胶芯	LCP	1	本色					

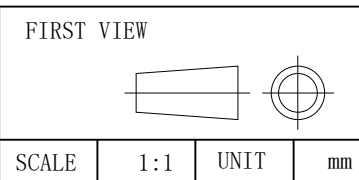

The copyright belongs to samzo parts [China] Co., Ltd. please use the material after samzo parts agree to authorize. The final right of interpretation belongs to samzo parts.  
 WWW.KKK-JP.COM

<b>TITLE::</b>	0.5MM 抽屉式 立贴 正脚位 2.0T
<b>DWG NO:</b>	5C3HF-P0101
<b>PART NO:</b>	5C3HF060211
<b>MODEL NO:</b>	5C3HF20-**
<b>NAME:</b>	FPC CONN

**SAMZO COMPONENTS**  
 Electronic switch and connector manufacturer