

61904-2RZ

Dimensions

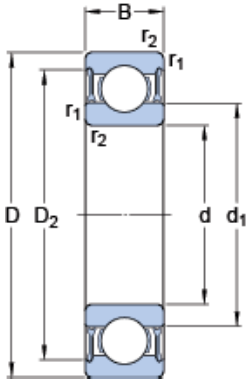

d	20	mm
D	37	mm
B	9	mm
d ₁	≈ 25.55	mm
D ₂	≈ 32.7	mm
r _{1,2}	min. 0.3	mm

Abutment dimensions

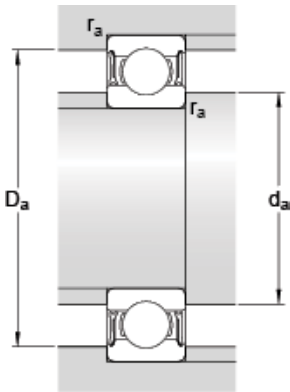

d _a	min. 22	mm
d _a	max. 25.5	mm
D _a	max. 35	mm
r _a	max. 0.3	mm

Calculation data

Basic dynamic load rating	C	6.37	kN
Basic static load rating	C ₀	3.65	kN
Fatigue load limit	P _u	0.156	kN
Reference speed		43000	r/min
Limiting speed		20000	r/min
Calculation factor	k _r	0.02	
Calculation factor	f ₀	14.7	

Mass

Mass bearing	0.038	kg
--------------	-------	----