

# SMD Power Inductor CDH30D11D/MB



Halogen Free



## Description

- Ferrite drum core construction.
- Semi-shielded with ferrite powder.
- L × W × H: 3.2 × 3.1 × 1.2 mm Max.
- Product weight: 38mg(Ref.)
- Moisture Sensitivity Level: 1
- RoHS compliance.
- Halogen Free available.

## Environmental Data

- Operating temperature range: -40°C~+105°C (including coil's self temperature rise)
- Storage temperature range: -40°C~+105°C
- Solder reflow temperature: 260 °C peak.

## Packaging

- Carrier tape and reel packaging.
- 13.0" diameter reel
- 4000pcs per reel

## Applications

- Ideally used in Mobile phone, PDA, MP3, DVC/DSC, HDD etc. as DC-DC converter inductors.

## Dimension - [mm]

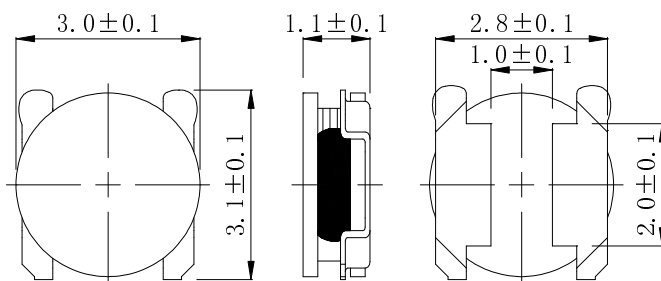

## Land pattern and Schematics - [mm]

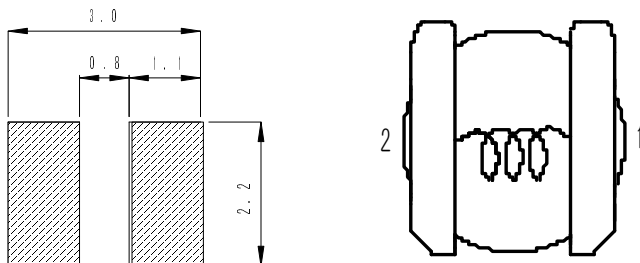

## Electrical Characteristics

Part No.	Stamp	Inductance ( $\mu$ H) [within] ※1	D.C.R. (m $\Omega$ ) [within] (at 20°C)	Saturation current (A) (at 20°C) ※2	Temperature rise current (A) ※3
CDH30D11DMBHF-1R0NC	A	1.0 ± 30%	45 ± 25%	1.96	2.40
CDH30D11DMBHF-1R5NC	C	1.5 ± 30%	53 ± 25%	1.63	2.20
CDH30D11DMBHF-2R2MC	E	2.2 ± 20%	68 ± 25%	1.40	1.95
CDH30D11DMBHF-3R3MC	G	3.3 ± 20%	95 ± 25%	1.15	1.70
CDH30D11DMBHF-4R7MC	J	4.7 ± 20%	170 ± 20%	0.96	1.27
CDH30D11DMBHF-6R8MC	L	6.8 ± 20%	225 ± 20%	0.79	1.06
CDH30D11DMBHF-100MC	N	10 ± 20%	360 ± 20%	0.66	0.80
CDH30D11DMBHF-150MC	Q	15 ± 20%	560 ± 20%	0.53	0.67

※1. Inductance measuring condition: at 100kHz.

※2. Saturation current: The value of D.C. current when the inductance decreases to 70% of it's nominal value.

※3. Temperature rise current: The value of D.C. current when the temperature rise is  $\Delta t = 40^\circ\text{C}$  ( $T_a = 20^\circ\text{C}$ ).

# SMD Power Inductor CDH30D11D/MB



## Saturation Current & Temperature Rise Graph

— L (20°C) — L (105°C) —  $\Delta T$

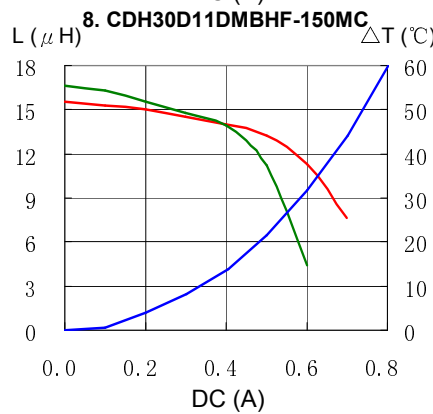
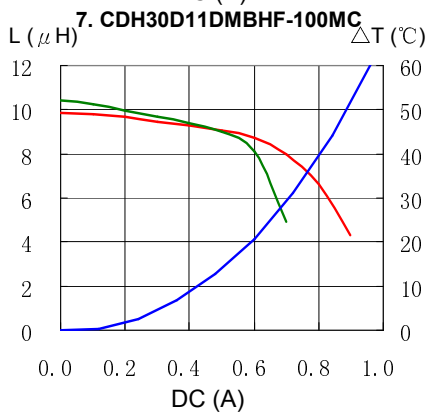
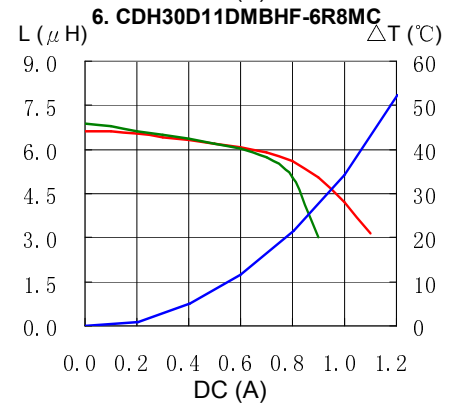
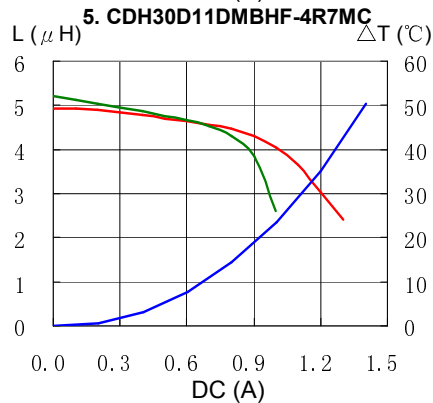
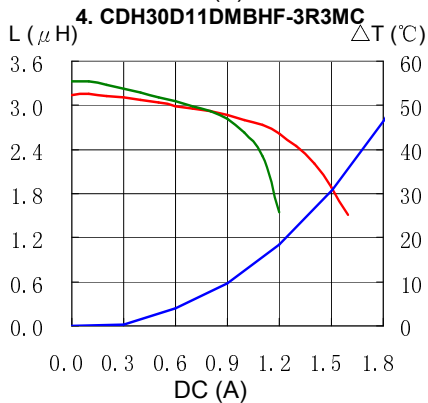
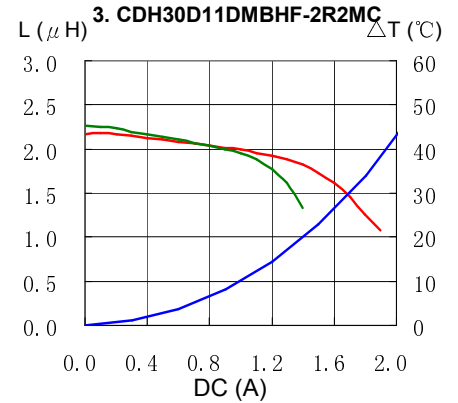
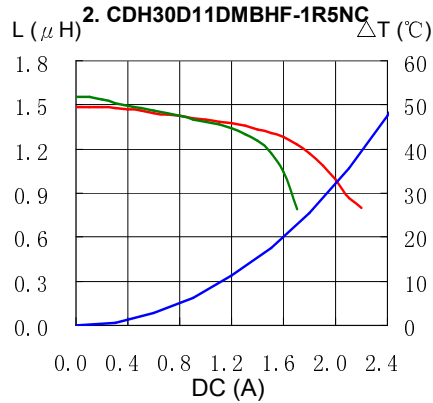
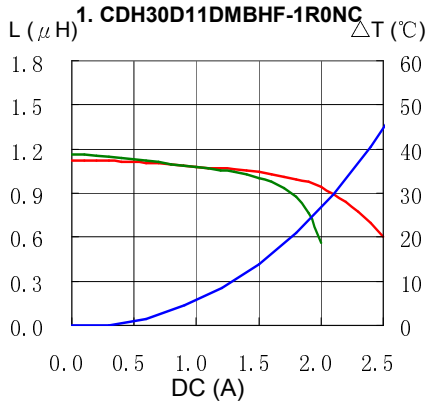

# SMD Power Inductor CDH30D11D/MB



## Solder Reflow Condition

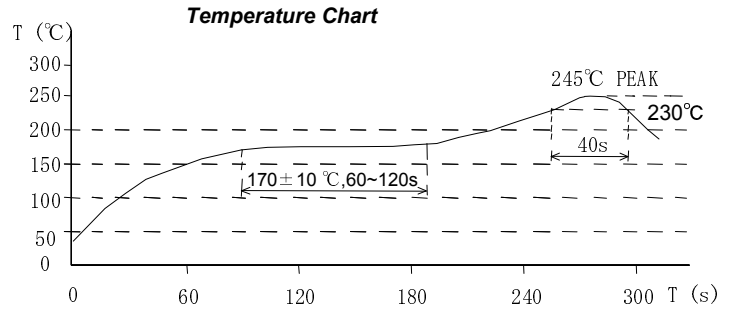
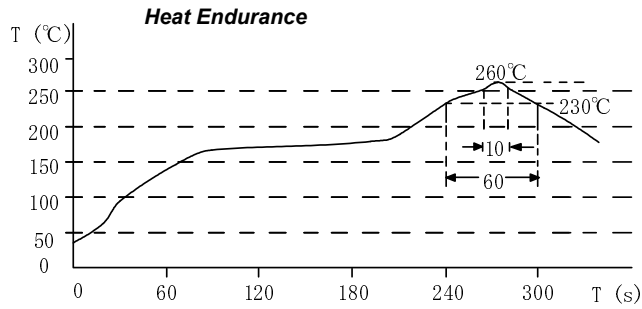

Please refer to the sales offices on our website - <http://www.sumida.com>

### Hong Kong

Tel.+852-2880-6781  
FAX.+852-2565-9600  
[sales@hk.sumida.com](mailto:sales@hk.sumida.com)

### Saitama(Japan)

Tel.+81-48-691-7300  
FAX.+81-48-691-7340  
[sales@jp.sumida.com](mailto:sales@jp.sumida.com)

### Chicago

Tel.+1-847-545-6700  
FAX. +1-847-545-6720  
[sales@us.sumida.com](mailto:sales@us.sumida.com)

### Shanghai

Tel.+86-21-5836-3299  
FAX.+86-21-5836-3266  
[shanghai.sales@cn.sumida.com](mailto:shanghai.sales@cn.sumida.com)

### Seoul

Tel.+82-2-6237-0777  
FAX.+82-2-6237-0778  
[sales@kr.sumida.com](mailto:sales@kr.sumida.com)

### Oberzell

Tel.+49-8591-937-0  
FAX. +49-8591-937-103  
[contact@eu.sumida.com](mailto:contact@eu.sumida.com)

### Shenzhen

Tel.+86-755-8291-0228  
FAX.+86-755-8291-0338  
[shenzhen.sales@cn.sumida.com](mailto:shenzhen.sales@cn.sumida.com)

### Singapore

Tel.+65-6296-3388  
FAX.+65-6841-4426  
[sales@sg.sumida.com](mailto:sales@sg.sumida.com)

### Neumarkt

Tel.+49-9181-4509-110  
FAX. +49-9181-4509-310  
[infocomp@eu.sumida.com](mailto:infocomp@eu.sumida.com)

### Taipei

Tel.+886-2-8751-2737  
FAX.+886-2-8751-2738  
[sales@tw.sumida.com](mailto:sales@tw.sumida.com)

### San Jose

Tel.+1-408-321-9660  
FAX.+1-408-321-9308  
[sales@us.sumida.com](mailto:sales@us.sumida.com)