



Twin extension block Connection main circuit: screw terminal 2 slots for compact load feeders

| General technical data  |     |  |                   |
|---|-----|--|-------------------|
| product brand name  |     | SIRIUS   |                   |
| product designation   |     | 2-expansion block  |                   |
| protection class IP on the front according to IEC 60529       |     | IP20; IP20 with box terminal/cover                                       |                   |
| touch protection on the front according to IEC 60529          |     | Finger-safe, for vertical contact  |                   |
| degree of pollution   |     | 3  |                   |
| number of slots for compact feeder                            |     | 2  |                   |
| installation altitude at height above sea level maximum       | m   | 2 000  |                   |
| ambient temperature   |     |  |                   |
| • during transport  | °C  | -55 ... +80  |                   |
| • during storage  | °C  | -55 ... +80  |                   |
| • during operation  | °C  | -20 ... +60  |                   |
| vibration resistance  |     | f = 4 to 5.8 Hz; d = 15 mm; f = 5.8 to 500 Hz; a = 2 m / s2 10 cycles    |                   |
| shock resistance  |     | Semi-sinusoidal a = 6 m/s2 at 10 ms; 3 pos. and 3 neg. Shock in all axes |                   |
| reference code  |     |  |                   |
| • according to IEC 81346-2                                    |     | K  |                   |
| • according to EN 61346-2                                     |     | K  |                   |
| Main circuit  |     |  |                   |
| operational current at AC at 400 V rated value                | A   | 63   |                   |
| operating voltage at AC-3 rated value maximum                 | V   | 690  |                   |
| Installation/ mounting/ dimensions                            |     |  |                   |
| fastening method  |     | screw and snap-on mounting   |                   |
| width   | mm  | 90   |                   |
| height  | mm  | 197  |                   |
| depth   | mm  | 100  |                   |
| Connections/ Terminals  |     |  |                   |
| type of electrical connection for main current circuit        |     | screw-type terminals   |                   |
| design of screw-type connection for main contacts             |     | M3   |                   |
| stripped length for main contacts                             | mm  | 10   |                   |
| tightening torque for main contacts with screw-type terminals | N·m | 2 ... 2.5  |                   |
| type of connectable conductor cross-sections for AWG cables   |     |  |                   |
| • for main contacts for load-side outgoing feeder             |     | 2 x (16 ... 10), 1 x (16 ... 8)  |                   |
| Certificates/ approvals                                       |     |  |                   |
| General Product Approval                                      | EMC | Declaration of Con-<br>formity   | Test Certificates |

[Confirmation](#)



[Type Test Certificates/Test Report](#)

Marine / Shipping

other



[Confirmation](#)

#### Further information

Siemens has decided to exit the Russian market (see here).

<https://press.siemens.com/global/en/pressrelease/siemens-wind-down-russian-business>

Siemens is working on the renewal of the current EAC certificates.

Please contact your local Siemens office on the status of validity of the EAC certification if you intend to import or offer to supply these products to an EAC relevant market (other than the sanctioned EAEU member states Russia or Belarus).

Information on the packaging

<https://support.industry.siemens.com/cs/ww/en/view/109813875>

Information- and Downloadcenter (Catalogs, Brochures,...)

<https://www.siemens.com/ic10>

Industry Mall (Online ordering system)

<https://mall.industry.siemens.com/mall/en/en/Catalog/product?mlfb=3RA6822-0AB>

Cax online generator

<http://support.automation.siemens.com/WW/CAXorder/default.aspx?lang=en&mlfb=3RA6822-0AB>

Service&Support (Manuals, Certificates, Characteristics, FAQs,...)

<https://support.industry.siemens.com/cs/ww/en/ps/3RA6822-0AB>

Image database (product images, 2D dimension drawings, 3D models, device circuit diagrams, EPLAN macros, ...)

[http://www.automation.siemens.com/bilddb/cax\\_de.aspx?mlfb=3RA6822-0AB&lang=en](http://www.automation.siemens.com/bilddb/cax_de.aspx?mlfb=3RA6822-0AB&lang=en)

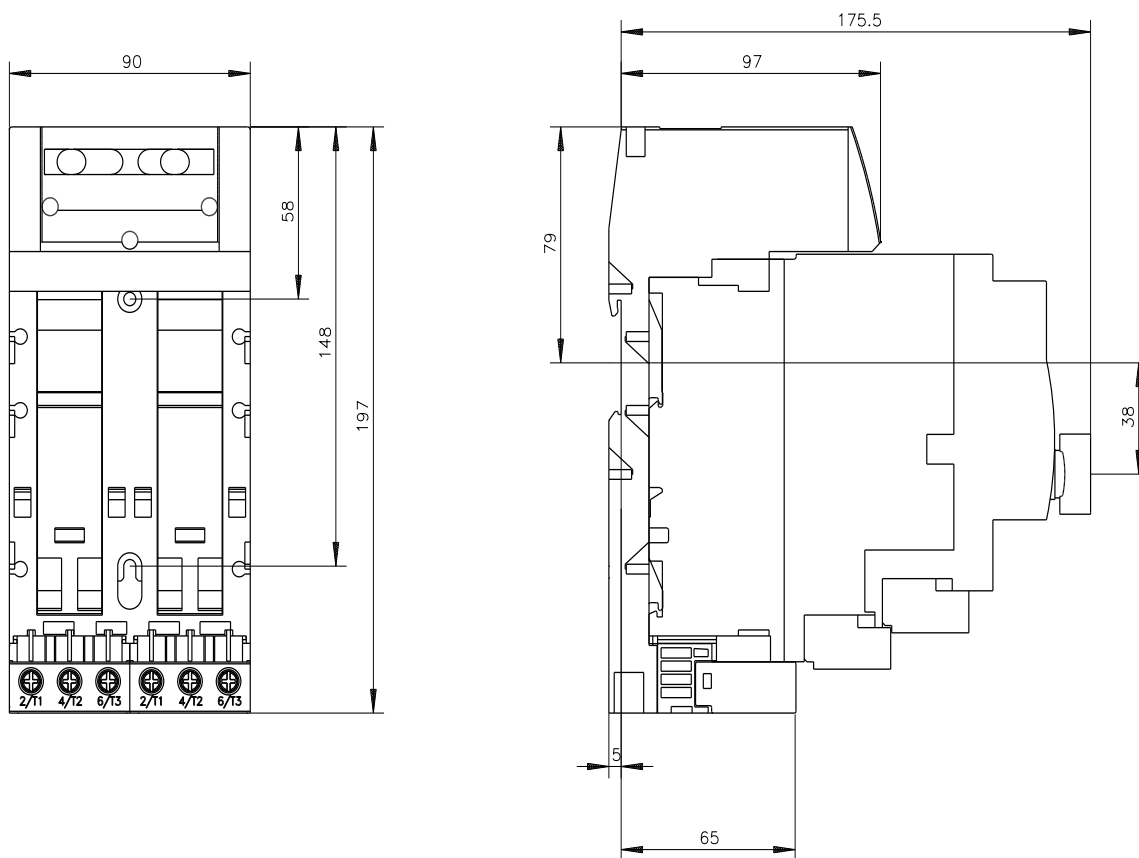

last modified:

12/15/2020