



Honeywell Pressure Switches

High Pressure: HP Series, HE Series

Factory set 150 psi to 4500 psi [10,34 bar to 310,26 bar]

Low Pressure: LP Series, LE Series

Factory set or field adjustable 3.5 psi to 150 psi [0,24 bar to 10,34 bar]



Honeywell Pressure Switches

HP Series, HE Series, LP Series, LE Series

Honeywell Pressure Switches are durable, reliable electromechanical gauge pressure on/off switches that are available with either single pole single throw (SPST) normally open or normally closed circuitry, or single pole double throw (SPDT) circuitry. Their IP67 environmental sealing and high proof pressure and burst pressure ratings allow for use in many rugged applications that require the making or breaking of an electrical connection in response to a pressure change of the system media.

The media (gas or liquid) pressure is applied via the port of the switch to a diaphragm or sealed piston. A pre-compressed spring on the other side of the sealed piston or diaphragm controls the set-point pressure. If the force resulting from the pressure is greater than the load on the spring, the electrical contacts within the switch will change state. If the contacts are normally open when no pressure is applied, they close on increasing pressure when the set point is reached. On decreasing pressure, the contacts will open again at a pressure somewhat less than the set switching point. The difference between the activation point on increasing pressure and the deactivation point on decreasing pressure is called hysteresis. The set point pressure for the switch can be configured such that the switch will actuate on increasing or decreasing system pressure.

Features

- Life cycle rating: up to 2 million
- IP67 sealing rating
- Operating temperature range: -40 °C to 120 °C [-40 °F to 248 °F]
- Proof pressure: 10000 psi [689 bar] (High Pressure), 500 psi [34,47 bar] (Low Pressure)
- Burst pressure: 20000 psi [1379 bar] (High Pressure), 750 psi for 3.5 psi to 22 psi, 1250 psi > 22 psi (Low Pressure)
- Hysteresis option (HP, HE, and LP Series only)
- Variety of pressure ports and electrical terminations
- Pressure switching set point range: Factory set 150 psi to 4500 psi [10,34 bar to 310,26 bar] (High Pressure) or factory set or field adjustable 3.5 psi to 150 psi [0,24 bar to 10,34 bar] (Low Pressure)
- Switching point accuracy: up to ± 2 %

Potential Applications

TRANSPORTATION

- Agricultural machinery
- Heavy duty construction machinery
- Heavy duty trucks
- Lawn & garden
- Marine vessels
- Material handling machinery
- Railway

INDUSTRIAL

- CNC machines
- Compressors, boilers
- Fracking equipment
- Food & beverage equipment
- Generators
- HVAC/R equipment
- Mud pumps
- Pneumatic equipment
- Presses and punches
- Pressure washers
- Trash compactors
- Water jet cutting machines
- Water pumps

LONG LIFE • HIGH PRODUCTIVITY • RELIABLE SWITCHING

Honeywell Pressure Switches

Table 2. Specifications

Characteristic	HP Series	HE Series	LP Series	LE Series
Product length (connector version AMP Super Seal)	see page 5	see page 5	see page 6	see page 6
Product length (blade)	see page 5	see page 5	see page 6	see page 6
Product length (wire out)	see page 5	see page 5	see page 6	see page 6
Hex size	27 mm	27 mm	27 mm	27 mm
Ease of installation	box spanner	box spanner	box spanner	box spanner
Snap-action switch	yes	yes	yes	no
Set point ¹ range	150 psi to 4500 psi	150 psi to 4500 psi	3.5 psi to 150 psi	3.5 psi to 150 psi
Set point ranges	6	6	4	4
Set point accuracy @ 25 °C (before test)	150 psi to 500 psi (±5 %) 500 psi to 4000 psi (±3.5 %) >4000 psi (±2 % [up to 2 %])	150 psi to 1000 psi (±14%) 1000 psi to 2000 psi (±12 %) 2000 psi to 4000 psi (±11 %) >4000 psi (±10 % [up to 10 %])	for 3.5 psi to 10 psi (±1 psi), for >10 psi to 50 psi (±3 psi), for >50 psi to 100 psi (±7 psi), for >100 psi to 150 psi (±10 psi)	for 3.5 psi to 10 psi (±1 psi), for >10 psi to 50 psi (±3 psi), for >50 psi to 100 psi (±7 psi), for >100 psi to 150 psi (±10 psi)
Average deadband	n/a	n/a	n/a	for 3.5 psi to 10 psi (±2.8 psi), for >10 psi to 50 psi (±14 psi), for >50 psi to 100 psi (±38 psi), for >100 psi to 150 psi (±40 psi)
Operating pressure ²	5,000 psi max.	5,000 psi max.	250 psi max.	250 psi max.
Proof pressure ³	10,000 psi	10,000 psi	500 psi	500 psi
Hysteresis	5 % to 55 % (based on set point range)	3 % to 65 % (based on set point range)	3 % to 50 % (based on set point range)	n/a
Burst pressure ⁴	20,000 psi	20,000 psi	750 psi for set points 3.5 psi to 22 psi, 1250 psi for set points > 22 psi	750 psi for set points 3.5 psi to 22 psi, 1250 psi for set points > 22 psi
Current rating (resistive)	5 A at 250 Vac 5 A at 24 Vdc	5 A at 250 Vac 3 A at 24 Vdc	7.5 mA to 5 A, 24 Vdc and 250 Vac	7.5 mA to 3 A, 24 Vdc and 250 Vac
Current rating (inductive)	5 A at 115 Vac (SX rating) 3 A at 28 Vdc	n/a	1 A at 28 Vdc	n/a
Temperature rating	-40 °C to 120 °C [-40 °F to 248 °F]	-40 °C to 85 °C [-40 °F to 185 °F]	-40 °C to 120 °C [-40 °F to 248 °F]	-40 °C to 120 °C [-40 °F to 248 °F]
Media connection	multiple ports available	multiple ports available	multiple ports available	multiple ports available
Pressure ports	M14 × 1.5, M18 × 1.5, 1/2-20 UNF, 9/16-18 UNF, 3/4-16 UNF, 7/8-14 UNF		1/4-18 NPT, 1/8-27 NPT, 1/2-20 UNF, 1/8-27 PTF, M12 × 1.5, M14 × 1.5, 9/16-18 UNF, 3/4-16 UNF, G1/8 BSPP, 7/16-20 UNF, R1/8 BSPT, M10 × 1.0, R1/2 BSPT, G1/4 BSPP, R1/4 BSPT	1/4-18 NPT, 1/8-27 NPT, 1/2-20 UNF, 1/8-27 PTF, M12 × 1.5, M14 × 1.5, 9/16-18 UNF, 3/4-16 UNF, G1/8 BSPP, 7/16-20 UNF, R1/8 BSPT, M10 × 1.0, R1/2 BSPT, G1/4 BSPP, R1/4 BSPT

HP Series, HE Series, LP Series, LE Series

Table 2. Specifications (continued)

Characteristic	HP Series	HE Series	LP Series	LE Series
Termination	AA = Spade Terminals BA = Screw Terminals CA = Deutsch DT04-3P-E005 (3-Pin Connector) DA = Amp Super Seal 1.5 - 282105-1 (3-Pin Connector) EA = 10-inch Cable, 18 AWG (Wire Out, No Connector) FA = 10-inch Cable w/Deutsch DT04-3P-E005 (3-Pin Connector) (16 AWG)* GA = 10-inch Cable w/Amp Super Seal 1.5 - 282105-1 (3-Pin Connector) (18 AWG)* HA = 10-inch Cable w/Metripack 280 Delphi 15300002 (2-Pin Connector) (18 AWG)* JA = 10-inch Cable w/Din43650-C (3-Pin Connector) (18 AWG)* KA = 10-inch Cable w/M12x1 (Brad Harrison Micro) - 21032121306 Harting P/N (3-Pin Connector) (18 AWG)* LA = 10-inch Cable w/Packard Weatherpack Male Terminal - 12020827 (3-Pin Connector) (18 AWG) MA = 10-inch Cable w/Deutsch DT04-2P-E005 (2-Pin Connector) (18 AWG) NA = 3-inch Cable w/Packard 2P Tower Connector - 12015792 (2-Pin Connector) (18 AWG) PA = 2.75-inch Cable w/Packard 2P Shroud Connector - 12010973 (2-Pin Connector) (18 AWG) RA = 4-inch Cable w/Packard 2P Shroud Connector - 12010973 (2-Pin Connector) (16 AWG) SA = 5.5-inch Cable w/ITT Cannon 2P Sure-Seal Circular Connector - SS2R-120-1804-000 (2-Pin Connector) (18 AWG) TA = 8.5-inch Cable w/ITT Cannon 3P Sure-Seal Circular Connector - SS3R-120-8551-001 (3-Pin Connector) (16 AWG)* UA = 10-inch Cable - Vacuum Impregnated w/Deutsch DT06-3S-EP06 (3-Socket Connector) (16 AWG)* VA = 10-inch Cable - Vacuum Impregnated w/Deutsch DT04-3P-E005 (3-Pin Connector) (16 AWG)* WA = 4.5-inch Cable w/Blade Terminals 6,3 mm x 0,8 mm (16 AWG)* YA = 6-inch Cable w/Amp Super Seal 1.5 - 282104-1 (2-Pin Connector) (18 AWG)* ZA = 10-inch Cable w/Deutsch DT06-2S-CE06 (2-Socket Connector) (18 AWG) AB = Deutsch DT04-2P-E005 (2-Pin Connector)** BB = 10-inch Cable w/Metripack 150 Delphi 12129615 (3-Pin Connector) (18 AWG)* DB = 10-inch Cable w/AMP 2,5 mm System Series Connector 1-967402-1 (18 AWG)* EB = 4.5-inch Cable w/Packard Shroud Connector 12015792 (2-Pin Connector) (18 AWG) FB = 10-inch Cable w/Metripack 150 Delphi 12052641 (2-Pin Connector) (18 AWG) GB = 10-inch Cable w/Deutsch Plug HD 16-3 96S (3-Pin Connector) (16 AWG)*			
Circuit forms ⁵	SPDT, SPST - NO/NC	SPDT, SPST - NO/NC	SPDT, SPST - NO/NC	SPDT, SPST - NO/NC
Life	2 million	1 million	2 million	1 million
Agency approvals (special use switches)	UL pending	UL pending	UL pending	UL pending
Agency approvals (other)	CE	CE	CE pending	CE pending
Field adjustability ⁶	no	no	yes	yes
Spike dampening	yes	yes	no	no
Ingress protection ⁷	IP67	IP67	IP67	IP67
Vibration resistance	10 Hz to 2000 Hz at 15 g 20 min/sweep	10 Hz to 2000 Hz at 15 g 20 min/sweep	10 Hz to 2000 Hz at 15 g 20 min/sweep	10 Hz to 2000 Hz at 15 g 20 min/sweep
Shock resistance	500 m/sec ² , 11 mSEC, 100 shocks / axis	500 m/sec ² , 11 mSEC, 100 shocks / axis	500 m/sec ² , 11 mSEC	500 m/sec ² , 11 mSEC
Wetted part (diaphragm)	n/a	n/a	Kapton® (Teflon® coated), Tefzel®	Kapton® (Teflon® coated), Tefzel®
Wetted part (piston)	nitrile or EPDM O-ring, steel piston	nitrile or EPDM O-ring, steel piston	n/a	n/a
Weight	0,133 g [4.7 oz]	0,133 g [4.7 oz]	0,058 kg [2.0 oz]	0,053 kg [1.9 oz]
Contacts	silver / gold inlay	silver	gold plated	gold plated
Product finish	zinc plating	zinc plating	zinc plating	zinc plating

¹Set point: Point at which switch actuates or de-actuates

²Operating pressure: Maximum normal system operating pressure (above set point)

³Proof pressure: Maximum pressure that the switch can handle while it maintains set point accuracy. Intermittent spikes to this level are acceptable.

⁴Burst pressure: Point of complete switch failure

⁵SPST: Single pole, single throw. SPDT: Single pole, double throw. NO: Normally open. NC: Normally closed.

⁶Field adjustability only available with AA, BA, CA, and DA (SPST only) terminations.

⁷IP00 for AA and BA terminations.

*These connectors are designed for dual circuit (SPDT) by default. They can be used for single-circuit applications (SPNC/SPNO) by making suitable connections. Refer to wiring diagram.

**Option AB is available only for LP and LE Series.

Honeywell Pressure Switches

DIMENSIONS - HIGH PRESSURE: HP SERIES, HE SERIES

Figure 1. AMP Superseal 1.5

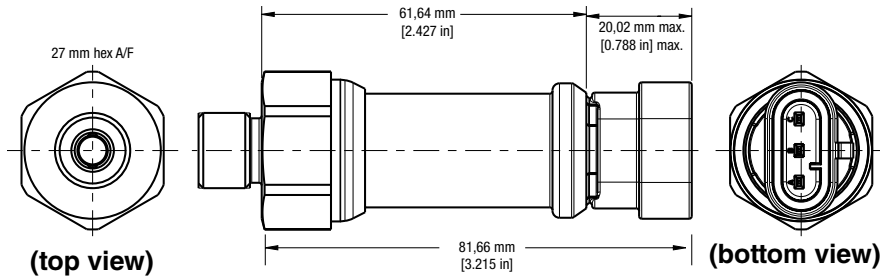

Female Connector Part Number (included): C-282105
Male Mating Connector (customer provided): C-282087
IP Rating: IP67

Figure 2. Deutsch

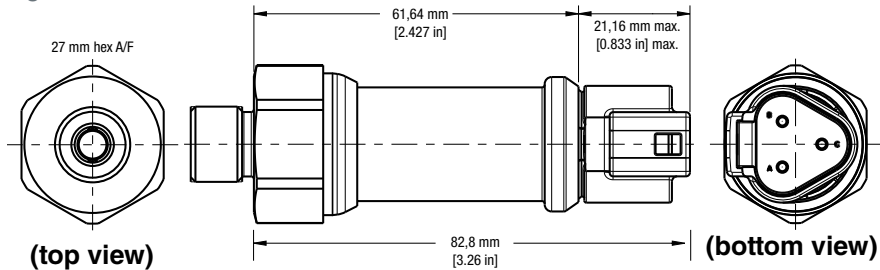

Female Connector Part Number (included): DT04-3P
Male Mating Connector (customer provided): DT06-3S
IP Rating: IP67

Figure 3. Spade Terminal

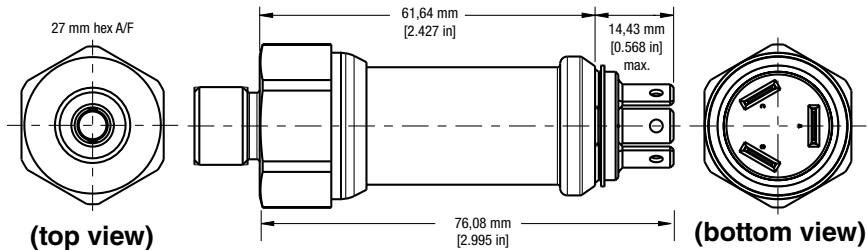

Figure 4. Screw Terminal

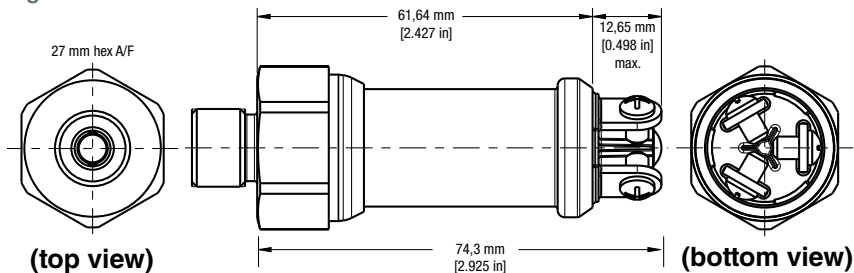
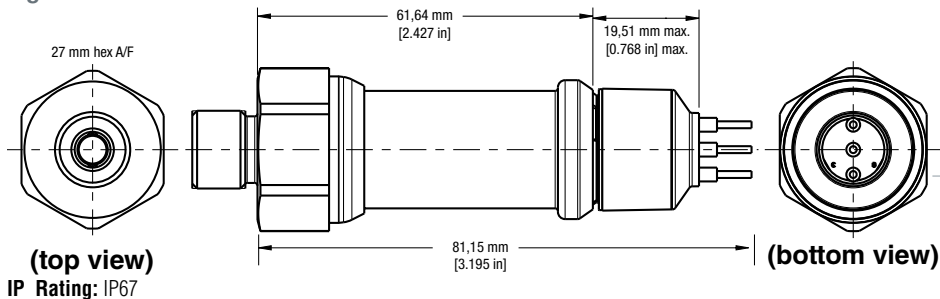

Figure 5. Cable



IP Rating: IP67

Figure 6. High Pressure Port Dimensions

1/2-20 UNF

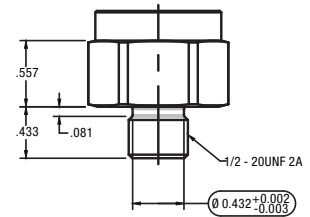

9/16-18 UNF

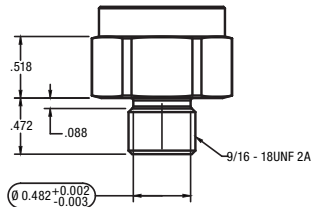

3/4-16 UNF

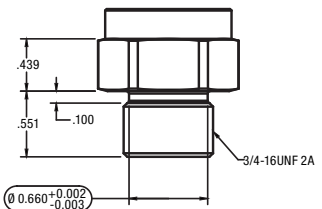

7/8-14 UNF

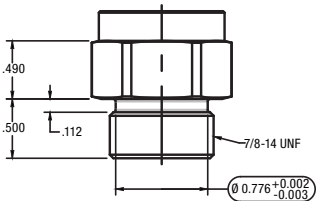

M14 x 1.5

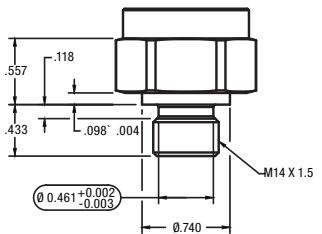

M18 x 1.5

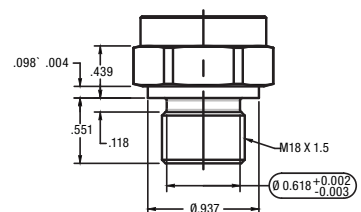

HP Series, HE Series, LP Series, LE Series

DIMENSIONS - LOW PRESSURE: LP SERIES, LE SERIES

Figure 7. AMP Superseal 1.5

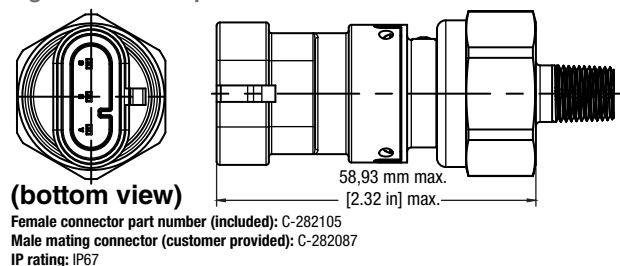

Figure 8. Deutsch 3-pin

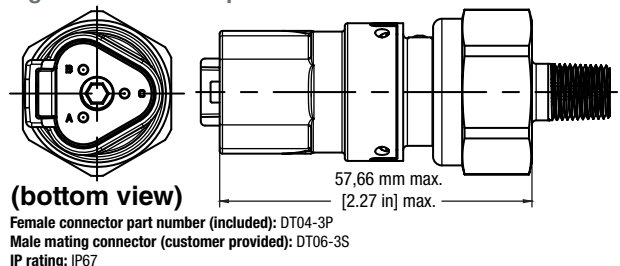

Figure 9. Deutsch 2-pin

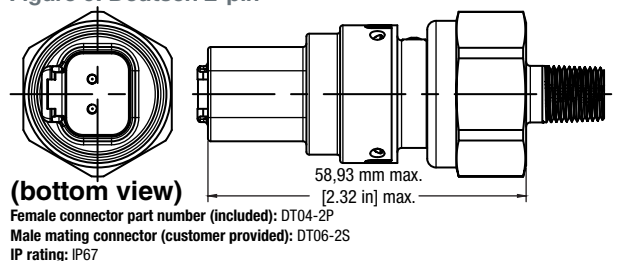

Figure 10. Wire out

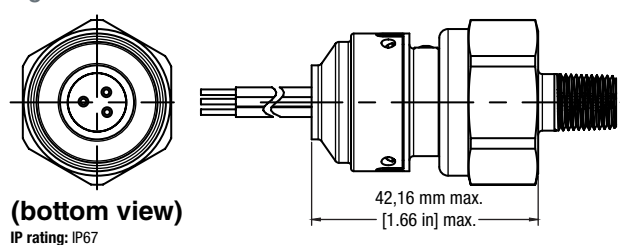

Figure 11. Spade terminal

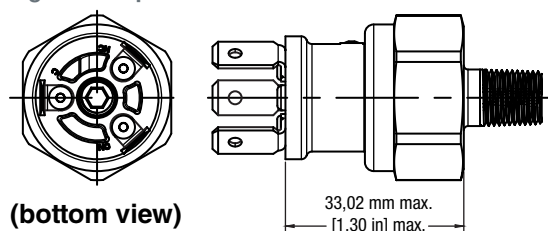

Figure 12. Screw terminal

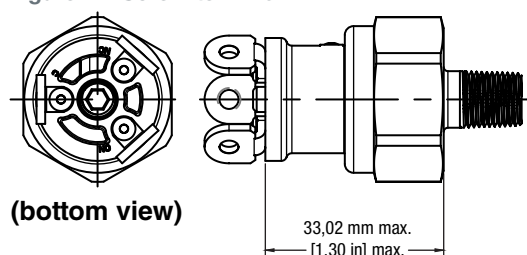

Figure 13. Low Pressure Port Dimensions

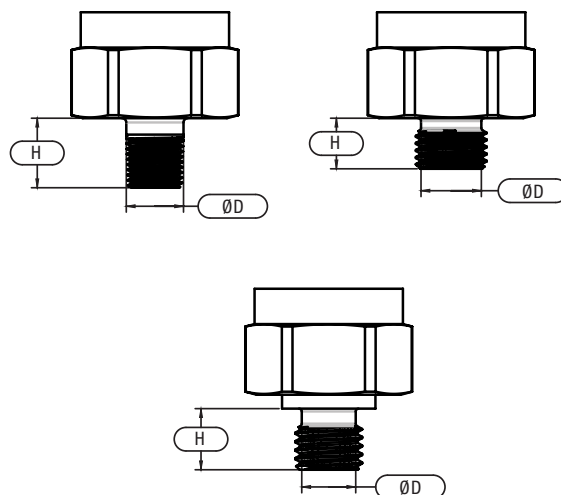

Table 3. Low Pressure Port Diameters and Heights

Port	Diameter "ØD"	Height "H"
R 1/2 BSPT	21,34 mm [0.840 in]	17,09 mm [0.673 in]
R 1/4 BSPT	13,46 mm [0.530 in]	13,74 mm [0.541 in]
R 1/8 BSPT	9,96 mm [0.392 in]	10,24 mm [0.403 in]
1/8-27 PTF	10,34 mm [0.407 in]	9,24 mm [0.364 in]
1/4-18 NPT	13,72 mm [0.540 in]	17,63 mm [0.694 in]
1/8-27 NPT	10,29 mm [0.405 in]	12,497 mm [0.492 in]
G 1/4 BSPP	11,1 mm [0.437 in]	11,20 mm [0.441 in]
G 1/8 BSPP	8,28 mm [0.326 in]	7,59 mm [0.299 in]
7/16-20 UNF	9,25 mm [0.364 in]	9,09 mm [0.358 in]
9/16-18 UNF	12,24 mm [0.482 in]	10,00 mm [0.394 in]
1/2-20 UNF	10,85 mm [0.427 in]	9,09 mm [0.358 in]
M14 × 1.5	11,71 mm [0.461 in]	10,998 mm [0.433 in]
M12 × 1.5	9,70 mm [0.382 in]	10,998 mm [0.433 in]
M10 × 1.0	8,41 mm [0.331 in]	8,51 mm [0.335 in]

Honeywell Pressure Switches

NOMENCLATURE: HIGH PRESSURE

For example, **HPR05500PFNSPAAA01** defines a high pressure switch, rising factory set, non-adjustable set point, 550 psi set point, psig, sealed gage pressure unit, M14 x 1.5 port type, SPST-NO silver contacts output, cold-rolled steel base, glycol-based fluid (EPDM) actuation/application, spade terminal connectors, standard switch, individually boxed units.

HP	R	05500	P	F	N	S	P	AA	A	01
Series	Set Point	Pressure Set Point	Pressure Unit	Port Type	Output	Base	Actuation/ Application	Connector Type	Options	Packaging Options
HP Series, HE Series High Pressure Switch	R Rising factory set, non-adjustable F Falling factory set, non-adjustable	10.34 bar to 310.26 bar [150 psi to 4500 psi] NOTE: Pressure set point is always five digits. For bar, the set point value will be multiplied by 100 and entered in the listing. For example, 15.45 Bar is noted as 01545. This allows for 2 decimal places. For psi, the set point value will be multiplied by 10 and entered in the listing. For example, 245.5 psi is noted as 02455. This allows for 1 decimal place.	P psig, sealed gage B bar, sealed gage	C 1/2-20 UNF* F M14 x 1.5** G 9/16-18 UNF** H 3/4-16 UNF K M18 x 1.5 N 7/8-14 UNF	N SPST-NO, silver contacts C SPST-NC, silver contacts D SPDT-NO/NC, silver contacts H NO, gold inlay contacts J NC, gold inlay contacts K SPDT(NO/NC), gold inlay contacts	S Cold-rolled steel V Stainless steel	N Petroleum-based hydraulic fluid (Nitrile) P Glycol-based fluid (EPDM)	AA 1/4 in Spade Terminals BA Screw Terminals CA Deutsch DT04-3P-E005 (3-Pin Connector) DA Amp Super Seal 1.5 - 282105-1 (3-Pin Connector) EA 10-inch Cable, 18 AWG (Wire Out, No Connector) FA 10-inch Cable w/Deutsch DT04-3P-E005 (3-Pin Connector) (16 AWG)* GA 10-inch Cable w/Amp Super Seal 1.5 - 282105-1 (3-Pin Connector) (18 AWG)* HA 10-inch Cable w/Metripack 280 Delphi 15300002 (2-Pin Connector) (18 AWG)* JA 10-inch Cable w/ Dink43650-C (3-Pin Connector) (18 AWG)* KA 10-inch Cable w/M12x1 (Brad Harrison Micro) - 21032121306 Harting P/N (3-Pin Connector) (18 AWG)* LA 10-inch Cable w/Packard Weatherpack Male Terminal - 12020827 (3-Pin Connector) (18 AWG) MA 10-inch Cable w/Deutsch DT04-2P-E005 (2-Pin Connector) (18 AWG) NA 3-inch Cable w/Packard 2P Tower Connector - 12015792 (2-Pin Connector) (18 AWG) PA 2.75-inch Cable w/Packard 2P Shroud Connector - 12010973 (2-Pin Connector) (18 AWG) RA 4-inch Cable w/Packard 2P Shroud Connector - 12010973 (2-Pin Connector) (16 AWG) SA 5.5-inch Cable w/ITT Cannon 2P Sure-Seal Circular Connector - SS2R-120-1804-000 (2-Pin Connector) (18 AWG) TA 8.5-inch Cable w/ITT Cannon 3P Sure-Seal Circular Connector - SS3R-120-8551-001 (3-Pin Connector) (16 AWG)* UA 10-inch Cable - Vacuum Impregnated w/Deutsch DT06-3S-EP06 (3-Socket Connector) (16 AWG)* VA 10-inch Cable - Vacuum Impregnated w/Deutsch DT04-3P-E005 (3-Pin Connector) (16 AWG)* WA 4.5-inch Cable w/ 1/4 in Spade Terminals 6.3 mm x 0.8 mm (16 AWG)* YA 6-inch Cable w/Amp Super Seal 1.5 - 282104-1 (2-Pin Connector) (18 AWG)* ZA 10-inch Cable w/Deutsch DT06-2S-CE06 (2-Socket Connector) (18 AWG) AB Deutsch DT04-2P-E005 (2-Pin Connector)** BB 10-inch Cable w/Metripack 150 Delphi 12129615 (3-Pin Connector) (18 AWG)* DB 10-inch Cable w/AMP 2.5 mm System Series Connector 1-967402-1 (18 AWG)* EB 4.5-inch Cable w/Packard Shroud Connector 12015792 (2-Pin Connector) (18 AWG) FB 10-inch Cable w/Metripack 150 Delphi 12052641 (2-Pin Connector) (18 AWG) GB 10-inch Cable w/Deutsch Plug HD 16-3 96S (3-Pin Connector) (16 AWG)*	A Standard switch B With 3 shrink sleeve C With shrink sleeve (plastic coating) D With shrink sleeve (acrylic coating) E With 1/8 watt resistor between terms. F 304.8 mm [12 in] total wire length G With conduit sleeve	01 Individually boxed units 15 25 individual boxes packed in bulk packaging 20 50 individual boxes packed in bulk packaging 25 25 units in bulk packaging 50 50 individual parts in bulk packaging

* not applicable for 10.3 bar to 65.5 bar [150 psi to 950 psi]

** not applicable for 10.3 bar to 24.1 bar [150 psi to 350 psi]

*These connectors are designed for dual circuit (SPDT) by default. They can be used for single-circuit applications (SPST/SPNO) by making suitable connections. Refer to wiring diagram.
**Option AB is available only for LP and LE Series.

HP Series, HE Series, LP Series, LE Series

NOMENCLATURE: LOW PRESSURE

For example, **LPR00550PFPVKAAA01** defines a low pressure switch, rising factory set, non-adjustable set point, 55 psi set point, psig, sealed gage pressure unit, M14 x 1.5 port type, SPST-NO gold-plated contacts output, stainless steel base, Kapton® diaphragm (Teflon® coated), Nitrile O-ring actuation/application, spade terminal connectors, standard switch, individually boxed units.

LP	R	00550	P	F	P	V	K	AA	A	01
Series	Set Point	Pressure Set Point	Pressure Unit	Port Type	Output	Base	Actuation/ Application	Connector Type	Options	Packaging Options
LP Series, LE Series Low Pressure Switch	R Rising factory set, non-adjustable	0.24 bar to 10.34 bar [3.5 psi to 150 psi]	P psig, sealed gage	A 1/4-18 NPT	P SPST-NO, gold-plated contacts	B Brass	K Kapton diaphragm (Teflon coated), Nitrile O-ring ¹	AA 1/4 in Spade Terminals	A Standard switch	01 Individually boxed units
	F Falling factory set, non-adjustable	NOTE: Pressure set point is always five digits. For bar, the set point value will be multiplied by 100 and entered in the listing. For example, 15.45 Bar is noted as 01545. This allows for 2 decimal places. For psi, the set point value will be multiplied by 100 and entered in the listing. For example, 245.5 psi is noted as 02455. This allows for 1 decimal place.	B bar, sealed gage	B 1/8-27 NPT	M SPST-NC, gold-plated contacts	N Cold-rolled steel	H Kapton diaphragm (Teflon coated), EPDM O-ring ²	BA Screw Terminals	B With 3 shrink sleeve	15 25 individual boxes packed in bulk packaging
	T Rising, field adjustable*		M bar, true gage	C 1/2-20 UNF	Y SPDT-NO/NC, gold-plated contacts	V Stainless steel	T Tefzel diaphragm, Nitrile O-ring ³	CA Deutsch DT04-3P-E005 (3-Pin Connector)	C With shrink sleeve (plastic coating)	20 150 units in bulk packaging
	C Falling, field adjustable*		T psig, true gage	D 1/8-27 PTF			U Tefzel diaphragm, EPDM O-ring ⁴	DA Amp Super Seal 1.5 - 282105-1 (3-Pin Connector)	D With shrink sleeve (acrylic coating)	
	* Field adjustable option is only available for: 1. Blade and screw terminations (SPDT, SPNO, SPNC) 3. Amp Supersseal 1.5 (3-pin) (SPNO & SPNC)		Blade and screw electrical terminations are available with only the true gage option.	E M12 x 1.5			¹ Air, Petroleum-based hydraulic fluid, engine oil ² Glycol-based fluid ³ For high temperature fluid media ⁴ For high temperature fluid media, glycol-based fluid	EA 10-inch Cable, 18 AWG (Wire Out, No Connector)	E With 1/8 watt resistor between terms.	
			True gage option is available only up to 20 psig set point for integral connectors and wire out electrical terminations.	F M14 x 1.5				FA 10-inch Cable w/Deutsch DT04-3P-E005 (3-Pin Connector) (16 AWG)*	F 304.8 mm [12 in] total wire length	
				G 9/16-18 UNF				GA 10-inch Cable w/Amp Super Seal 1.5 - 282105-1 (3-Pin Connector) (16 AWG)*	G With conduit sleeve	
				H 3/4-16 UNF				HA 10-inch Cable w/Metripack 280 Delphi 15300002 (2-Pin Connector) (18 AWG)*	R With port neck o-ring	
				J G1/8 BSPP				JA 10-inch Cable w/Din43650-C (3-Pin Connector) (18 AWG)*		
				M 7/16-20 UNF				KA 10-inch Cable w/M12x1 Brad Harrison Micro - 21032121306 Harting P/N (3-Pin Connector) (18 AWG)*		
				R R1/8 BSPT				LA 10-inch Cable w/Packard Weatherpack Male Terminal - 12020827 (3-Pin Connector) (16 AWG)		
				T M10 x 1.0				MA 10-inch Cable w/Deutsch DT04-2P-E005 (2-Pin Connector) (18 AWG)		
				V R1/2 BSPT				NA 3-inch Cable w/Packard 2P Tower Connector - 12015792 (2-Pin Connector) (18 AWG)		
				Y G1/4 BSPP				PA 2.75-inch Cable w/Packard 2P Shroud Connector - 12010973 (2-Pin Connector) (18 AWG)		
				Z R1/4 BSPT				RA 4-inch Cable w/Packard 2P Shroud Connector - 12010973 (2-Pin Connector) (16 AWG)		
								SA 5.5-inch Cable w/ITT Cannon 2P Sure-Seal Circular Connector - SS2R-120-1804-000 (2-Pin Connector) (18 AWG)		
								TA 8.5-inch Cable w/ITT Cannon 3P Sure-Seal Circular Connector - SS3R-120-8551-001 (3-Pin Connector) (16 AWG)		
								UA 10-inch Cable - Vacuum Impregnated w/Deutsch DT06-3S-EP06 (3-Socket Connector) (16 AWG)*		
								VA 10-inch Cable - Vacuum Impregnated w/Deutsch DT04-3P-E005 (3-Pin Connector) (16 AWG)*		
								WA 4.5-inch Cable w/ 1/4 in Spade Terminals 6.3 mm x 0.8 mm (16 AWG)*		
								YA 6-inch Cable w/Amp Super Seal 1.5 - 282104-1 (2-Pin Connector) (18 AWG)*		
								ZA 10-inch Cable w/Deutsch DT06-2S-CE06 (2-Socket Connector) (18 AWG)		
								AB Deutsch DT04-2P-E005 (2-Pin Connector)**		
								BB 10-inch Cable w/Metripack 150 Delphi 12129615 (3-Pin Connector) (18 AWG)*		
								DB 10-inch Cable w/AMP 2.5 mm System Series Connector 1-987402-1 (18 AWG)*		
								EB 4.5-inch Cable w/Packard Shroud Connector 12015792 (2-Pin Connector) (18 AWG)		
								FB 10-inch Cable w/Metripack 150 Delphi 12052641 (2-Pin Connector) (18 AWG)		
								GB 10-inch Cable w/Deutsch Plug HD 18-3 96S (3-Pin Connector) (16 AWG)*		

*These connectors are designed for dual circuit (SPDT) by default. They can be used for single-circuit applications (SPNC/SPNO) by making suitable connections. Refer to wiring diagram.
**Option AB is available only for LP and LE Series.

Honeywell Pressure Switches

ADDITIONAL INFORMATION

The following associated literature is available on the Sensing and Control web site at sensing.honeywell.com:

- Product installation instructions
- Product range guide
- Product application-specific information

WARNING

PERSONAL INJURY

DO NOT USE these products as safety or emergency stop devices or in any other application where failure of the product could result in personal injury.

Failure to comply with these instructions could result in death or serious injury.

WARNING

MISUSE OF DOCUMENTATION

- The information presented in this product sheet is for reference only. Do not use this document as a product installation guide.
- Complete installation, operation, and maintenance information is provided in the instructions supplied with each product.

Failure to comply with these instructions could result in death or serious injury.

WARRANTY/REMEDY

Honeywell warrants goods of its manufacture as being free of defective materials and faulty workmanship. Honeywell's standard product warranty applies unless agreed to otherwise by Honeywell in writing; please refer to your order acknowledgement or consult your local sales office for specific warranty details. If warranted goods are returned to Honeywell during the period of coverage, Honeywell will repair or replace, at its option, without charge those items it finds defective. **The foregoing is buyer's sole remedy and is in lieu of all other warranties, expressed or implied, including those of merchantability and fitness for a particular purpose. In no event shall Honeywell be liable for consequential, special, or indirect damages.**

While we provide application assistance personally, through our literature and the Honeywell website, it is up to the customer to determine the suitability of the product in the application.

Specifications may change without notice. The information we supply is believed to be accurate and reliable as of this printing. However, we assume no responsibility for its use.

Find out more

Honeywell serves its customers through a worldwide network of sales offices, representatives and distributors. For application assistance, current specifications, pricing or name of the nearest Authorized Distributor, contact your local sales office.

To learn more about Honeywell's sensing and control products, call **+1-815-235-6847** or **1-800-537-6945**, visit **sensing.honeywell.com**, or e-mail inquiries to **info.sc@honeywell.com**

Sensing and Control
Honeywell
1985 Douglas Drive North
Golden Valley, MN 55422
honeywell.com

The Honeywell logo, consisting of the word "Honeywell" in a bold, red, sans-serif font.

50094081-3-EN IL50 GLO
May 2014

Copyright © 2014 Honeywell International Inc. All rights reserved.

® DuPont™, Teflon®, Tefzel®, and Kapton® are trademarks or registered trademarks of E.I. du Pont de Nemours and Company.