

# Illuminated pushbutton Ø 22 mm silver contact

82-6151.1114



<https://eao.com/p/82-6151.1114>

Your product:

---



## 82-6151.1114

### Illuminated pushbutton Ø 22 mm silver contact

#### FRONT

<b>Front bezel material:</b>	Stainless steel
<b>Front form:</b>	round
<b>Front dimension:</b>	Ø 25 mm
<b>Front bezel shape:</b>	flush

#### MOUNTING

<b>Mounting type:</b>	Panel mounting
<b>Mounting cut-out:</b>	Ø 22 mm

#### OPERATING-/INDICATION PART

<b>Lens optics:</b>	opaque
<b>Lens colour:</b>	Silver
<b>Shape of illumination:</b>	Ring
<b>Lens illumination:</b>	illuminative
<b>Illumination colour:</b>	Red
<b>Lens shape:</b>	flush
<b>Lens material:</b>	Stainless steel

#### ELECTRICAL CHARACTERISTICS

<b>Operation current:</b>	7 mA
<b>Pollution degree:</b>	2, according to EN IEC 60947-1
<b>Operating voltage:</b>	24 V AC/DC

**Switching voltage and switching current:**

according to IEC 60947-5-1 (Silver contacts)	
Service categorie AC-15	
Voltage	Current
24 VAC	1 A
35 VAC	1 A (M12 versio
110 VAC	1 A
220 VAC	0.5 A
Switch rating DC service categorie DC-13 (Silver contacts)	
Voltage	Current
24 VDC	0.7 A
35 VDC	0.5 A (M12 vers
110 VDC	0.2 A
220 VDC	0.1 A

according to UL 508 (Silver contacts)

$\cos\phi$ 0,75 ... 0,8	
Voltage	Current
120 VAC	5 A
240 VAC	3 A
24 VAC	1 A

<b>Rated Operational Voltage Ue:</b>	250 VAC
<b>Thermal current Ith:</b>	5 A
<b>Contacts:</b>	1 C
<b>Rated insulation voltage Ui:</b>	250 V
<b>Electrical lifetime:</b>	50 000 cycles of operation
<b>Electric strength:</b>	1500 VAC, 50 Hz 1 minute between life terminals and ground

**MECHANICAL CHARACTERISTIC**

<b>Switching system:</b>	Snap-action switching element
<b>Contact material:</b>	Silver
<b>Weight:</b>	0.018 kg
<b>Mechanical lifetime:</b>	1 Mio. cycles of operation
<b>Switching action:</b>	Momentary
<b>Operating Travel:</b>	ca. 3 mm
<b>Terminal:</b>	Soldering terminal, 2.8 x 0.5 mm
<b>Operating force:</b>	4 N ... 7 N
<b>Tightening torque:</b>	0.5 ... 0.6 Nm

**AMBIENT CONDITION**

<b>Storage temperature:</b>	- 40 °C ... + 80 °C
<b>Shock resistance:</b>	Max. 500 m / s <sup>2</sup> as per IEC 60068-2-27
<b>Vibration resistance:</b>	

10 ... 500 Hz, amplitude 1.5 mm p-p according to IEC 60068-2-6

**Climate resistance:** Damp heat, 21 days according to IEC 60512-11

**IP front protection:** IP65, IP67

**Operating temperature:** - 30 °C ... + 70 °C

**CERTIFICATE**

**Approbations:** CB, CCC, C UL, UL

**Conformities:** CE, 2011 / 65 / EC (RoHS), 2014 / 35 / EU (LVD)

**OTHER**

**Kind of illumination:** Single-LED

**Short Description:** Illuminated pushbutton Ø 22 mm silver contact, Momentary, 24 V AC/DC, 1 C, Soldering terminal, 2.8 x 0.5 mm, round, Stainless steel, Red, Silver

**Mounting cut-outs:**

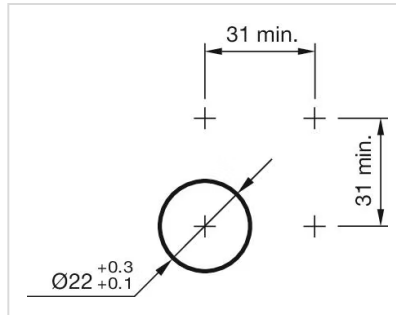

**Component layouts:**

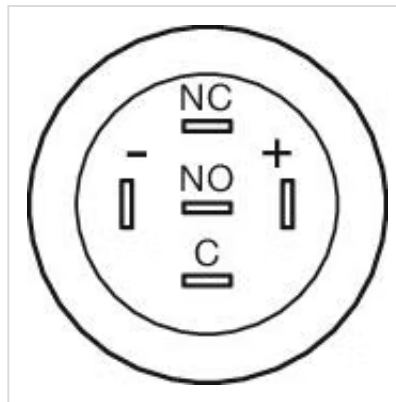

**Dimension drawings:**

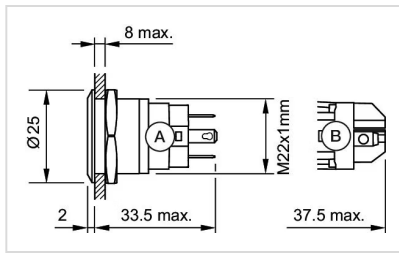

A = Solder terminal  
 B = Screw terminal

**Wiring diagrams:**

