

NOTES:

- 1. MATERIALS:
 CONTACT: BERYLLIUM COPPER
 ALL OTHER METAL PARTS: STAINLESS STEEL
 INSULATOR: ULTEM1000
- 2. FINISH:
 CONTACT: GOLD
 ALL OTHER METAL PARTS: PASSIVATED
- 3. MECHANICAL/ENVIRONMENTAL:
 DURABILITY: 500 CYCLES
- 4. ELECTRICAL:
 IMPEDANCE: 50Ω
 FREQUENCY RANGE: DC to 50GHz
 VSWR(dB): 1.2:1 (-20.83dB)

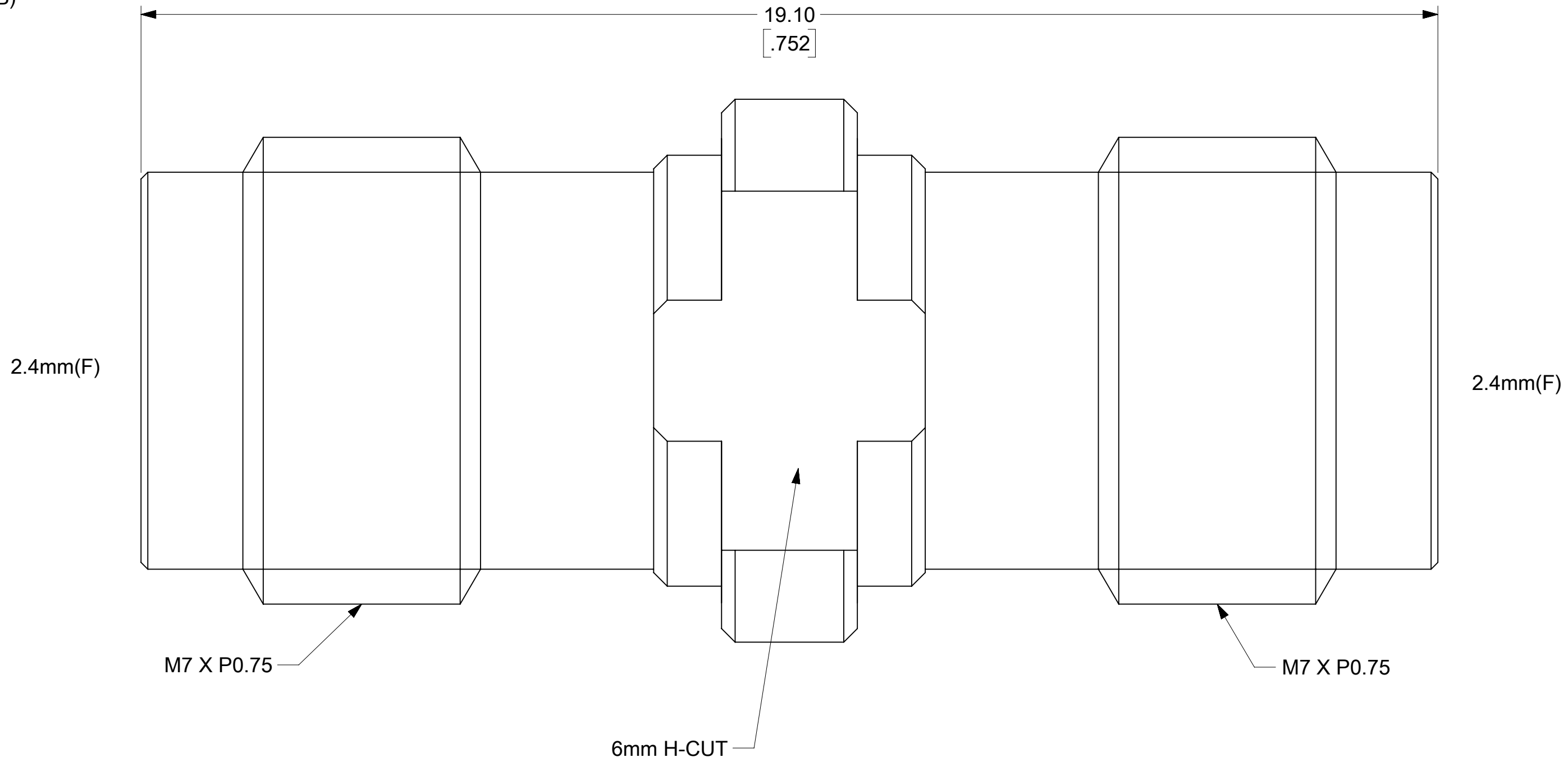

FUNCTIONAL SYMBOLS	THIS DRAWING CONTAINS INFORMATION THAT IS PROPRIETARY TO MOLEX ELECTRONIC TECHNOLOGIES, LLC AND SHOULD NOT BE USED WITHOUT WRITTEN PERMISSION									
	DIMENSION UNITS	SCALE		CURRENT REV DESC: UPDATED TO GENERAL MARKET			molex			
$\frac{F}{A} = 0$	MM/INCH	NTS		EC NO: 735515				2.4MM JACK TO 2.4MM JACK ADAPTER		
$\frac{F}{C} = 0$	GENERAL TOLERANCES (UNLESS SPECIFIED)			DRWN: KTAGAN 2023/01/18						
$\frac{F}{P} = 0$		MM	INCH	CHK'D: LMEIER 2023/01/18						
DIVISIONAL SYMBOLS	4 PLACES	±	±	APPR: JBORRELLI 2023/01/19			PRODUCT CUSTOMER DRAWING			
	3 PLACES	±	±	INITIAL REVISION:						
	2 PLACES	±	±	DRWN: VISHNM2 2022/11/24						
	1 PLACE	±	±	APPR: LMEIER 2022/12/15						
	0 PLACES	±	±	ANGULAR TOL ± °						
DRAFT WHERE APPLICABLE MUST REMAIN WITHIN DIMENSIONS				THIRD ANGLE PROJECTION	DRAWING	SERIES	DOCUMENT NUMBER	DOC TYPE	DOC PART	REVISION
					C-SIZE	73387	733870070	PSD	000	A1
				MATERIAL NUMBER		CUSTOMER	SHEET NUMBER			
				733870070			1 OF 1			