

# Inductive Rectangular Sensors

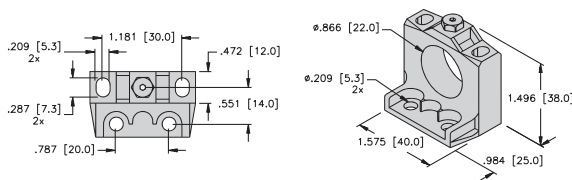

Housing Style - Rectangular	Part Number	ID Number	Features	Embeddable	Sensing Range (mm)	Output	
<b>CK40 - Embeddable/Nonembeddable, eurofast® Connector</b> 	Bi 15U-CK40-AD4X-H1144	M4280032	<i>Uprox+</i>	•	15	2-Wire DC	
	Ni 35U-CK40-AD4X-H1144	M4280232	<i>Uprox+</i>		35		
	Bi 15-CK40-AD4X-H1141 W/Bs2.1	M4465090		•	15		
	Ni 20-CK40-AD4X-H1141 W/BS2.1	M4465290			20		
	Bi 15U-CK40-AN6X2-H1141 W/BS 2.1	M1625690	M1625690	<i>Uprox</i>	•	15	3-Wire DC NPN
	Bi 20U-CK40-AN6X2-H1141 W/BS 2.1	M1627231	M1627231	<i>Uprox+</i>	•	20	
	Bi 30U-CK40-AN6X2-H1141 W/BS 4	M1625820	M1625820	<i>Uprox+</i>	•	30	
	Bi 15-CK40-AN6X2-H1141 W/BS 2.1	M1625190	M1625190		•	15	
	Ni 20-CK40-AN6X2-H1141 W/BS 2.1	M1625390	M1625390			20	
	Ni 25U-CK40-AN6X2-H1141 W/BS 2.1	M1625789	M1625789	<i>Uprox</i>		25	
	Ni 35U-CK40-AN6X2-H1141 W/BS 4	M1625810	M1625810	<i>Uprox</i>		35	
	Ni 50U-CK40-AN6X2-H1141 W/BS 4	M1625823	M1625823	<i>Uprox+</i>		50	
	Bi 15U-CK40-AP6X2-H1141 W/BS 2.1	M1625689	M1625689	<i>Uprox</i>	•	15	3-Wire DC PNP
	Bi 20U-CK40-AP6X2-H1141 W/BS 2.1	M1627288	M1627288	<i>Uprox+</i>	•	20	
	Bi 30U-CK40-AP6X2-H1141 W/BS 4	M1625829	M1625829	<i>Uprox+</i>	•	30	
	Bi 15-CK40-AP6X2-H1141 W/BS 2.1	M1625090	M1625090		•	15	
	Ni 20-CK40-AP6X2-H1141 W/BS 2.1	M1625290	M1625290			20	
	Ni 25U-CK40-AP6X2-H1141 W/BS 2.1	M1625790	M1625790	<i>Uprox</i>		25	
	Ni 35U-CK40-AP6X2-H1141 W/BS 4	M1625800	M1625800	<i>Uprox</i>		35	
	Bi 15-CK40-VN4X2-H1141 W/BS 2.1	M1550190	M1550190	<i>Comp. Outputs</i>	•	15	4-Wire DC NPN
Ni 20-CK40-VN4X2-H1141 W/BS 2.1	M1550390	M1550390	<i>Comp. Outputs</i>		20		
Ni 50U-CK40-VN4X2-H1141 W/BS 2.1	M1625806	M1625806	<i>Uprox+</i> /Comp. Outputs		50		
Bi 15-CK40-VP4X2-H1141 W/BS 2.1	M1550091	M1550091	<i>Comp. Outputs</i>	•	15	4-Wire DC PNP	
Ni 20-CK40-VP4X2-H1141 W/BS 2.1	M1550290	M1550290	<i>Comp. Outputs</i>		20		
Ni 35U-CK40-VP6X2-H1141	M1625815	M1625815	<i>Uprox</i>		35		
Ni 50U-CK40-VP4X2-H1141 W/BS 2.1	M1538302	M1538302	<i>Uprox+</i> Comp. Outputs				
Bi 15-CK40-Y1X-H1141	M4065000	M4065000		•	15	2-Wire DC NAMUR	

Note: 1. BS2.1 is the standard mounting bracket for CK40 unless noted differently.



**BS 2.1 Mounting Bracket**

For detailed sensor specifications see Section M.  
Normally Closed versions available upon request, consult factory.

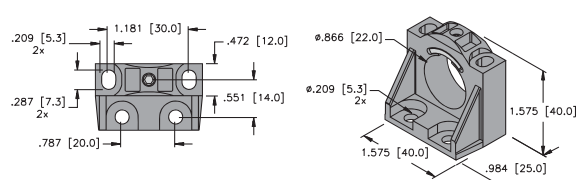

**BS 4 Mounting Bracket**



Voltage	Switching Freq. (Hz)	Operating Current (mA)	Operating Temp. (°C)	Protection	Housing	Front Cap/ Face	Power LED	Output LED	Mating Cord, Cable Length /Jacket	Wiring Diagram #	Wiring Diagrams
10-65 VDC	250	≤200	-20 to +70	IP 68	PBT	PBT	GN	YE	RK 4.23T-*	1	<b>Diagram 1</b> 
	250	≤200	-20 to +70	IP 68	PBT	PBT	GN	YE	RK 4.23T-*	1	
	150	≤100	-25 to +70	IP 67	PBT	PBT	GN	YE	RK 4.2T-*	2	
	200	≤100	-25 to +70	IP 67	PBT	PBT	GN	YE	RK 4.2T-*	2	
10-30 VDC	250	≤200	-30 to +85	IP 68	PBT	PBT	GN	YE	RK 4T-*	3	<b>Diagram 2</b>  <b>Diagram 3</b>  <b>Diagram 4</b>  <b>Diagram 5</b> 
	250	≤200	-20 to +70	IP 68	PBT	PBT	GN	YE	RK 4T-*	3	
	250	≤200	-10 to +60	IP 68	PBT	PBT	GN	YE	RK 4T-*	3	
	150	≤200	-25 to +70	IP 67	PBT	PBT	GN	YE	RK 4T-*	3	
	150	≤200	-25 to +70	IP 67	PBT	PBT	GN	YE	RK 4T-*	3	
	250	≤200	-30 to +85	IP 68	PBT	PBT	GN	YE	RK 4T-*	3	
	250	≤200	-30 to +85	IP 67	PBT	PBT	GN	YE	RK 4T-*	3	
	250	≤200	-25 to +70	IP 68	PBT	PBT	GN	YE	RK 4T-*	3	
10-30 VDC	250	≤200	-30 to +85	IP 68	PBT	PBT	GN	YE	RK 4T-*	4	<b>Diagram 6</b>  <b>Diagram 7</b> 
	250	≤200	-20 to +70	IP 68	PBT	PBT	GN	YE	RK 4T-*	4	
	250	≤200	-10 to +60	IP 68	PBT	PBT	GN	YE	RK 4T-*	4	
	150	≤200	-25 to +70	IP 67	PBT	PBT	GN	YE	RK 4T-*	4	
	150	≤200	-25 to +70	IP 67	PBT	PBT	GN	YE	RK 4T-*	4	
	250	≤200	-30 to +85	IP 68	PBT	PBT	GN	YE	RK 4T-*	4	
	250	≤200	-30 to +85	IP 67	PBT	PBT	GN	YE	RK 4T-*	4	
10-65 VDC	250	≤200	-25 to +70	IP 67	PBT	PBT	GN	YE	RK 4.4T-*	5	
	250	≤200	-25 to +70	IP 67	PBT	PBT	GN	YE	RK 4.4T-*	5	
	250	≤200	-25 to +70	IP 68	PBT	PBT	GN	YE	RK 4.4T-*	5	
10-65 VDC	250	≤200	-25 to +70	IP 67	PBT	PBT	GN	YE	RK 4.4T-*	6	
	250	≤200	-25 to +70	IP 67	PBT	PBT	GN	YE	RK 4.4T-*	6	
	250	≤200	-25 to +70	IP 67	PBT	PBT	GN	YE	RK 4.4T-*	6	
	250	≤200	-25 to +70	IP 68	PBT	PBT	GN	YE	RK 4.4T-*	6	
5-30 VDC	150	Remote	-25 to +70	IP 67	PBT	PBT	N/A	YE	RK 4.21T-*	7	

Rectangular

For material descriptions see page M36.