

| PRODUCT NUMBER | NB OF POS | DIM "A" | DIM "B" | POLARIZED POSITIONS | |
|----------------|-----------|---------|---------|---------------------|----|
| 65258-001(LF) | 2 x 06 | 15.87 | 34.87 | 1 | 6 |
| 65258-002(LF) | 2 x 07 | 19.05 | 38.05 | 1 | 7 |
| 65258-003(LF) | 2 x 10 | 28.57 | 47.57 | 1 | 10 |
| 65258-004(LF) | 2 x 12 | 34.92 | 53.92 | 1 | 12 |
| 65258-005(LF) | 2 x 04 | 9.52 | 28.52 | 1 | 4 |

WHEN NEEDED, SUFFIX LETTER "LF" INDICATES THE PRODUCT IS RoHS COMPLIANT, SEE NOTE 4

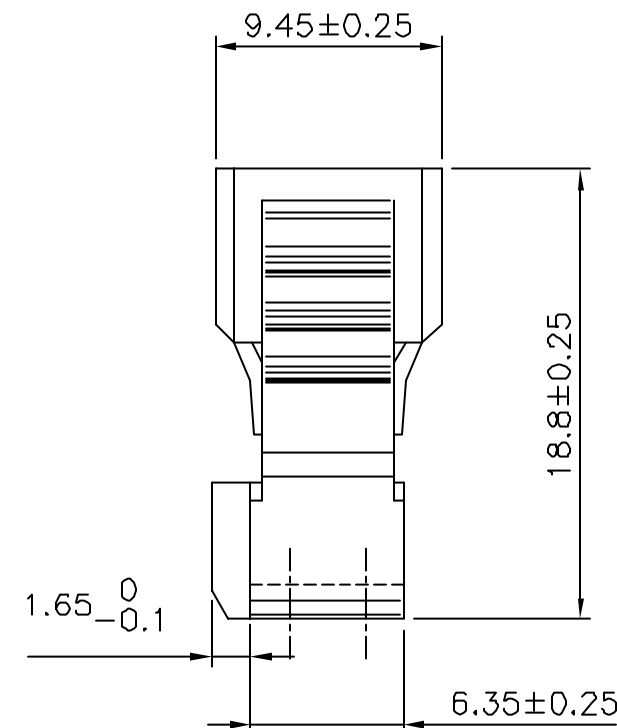
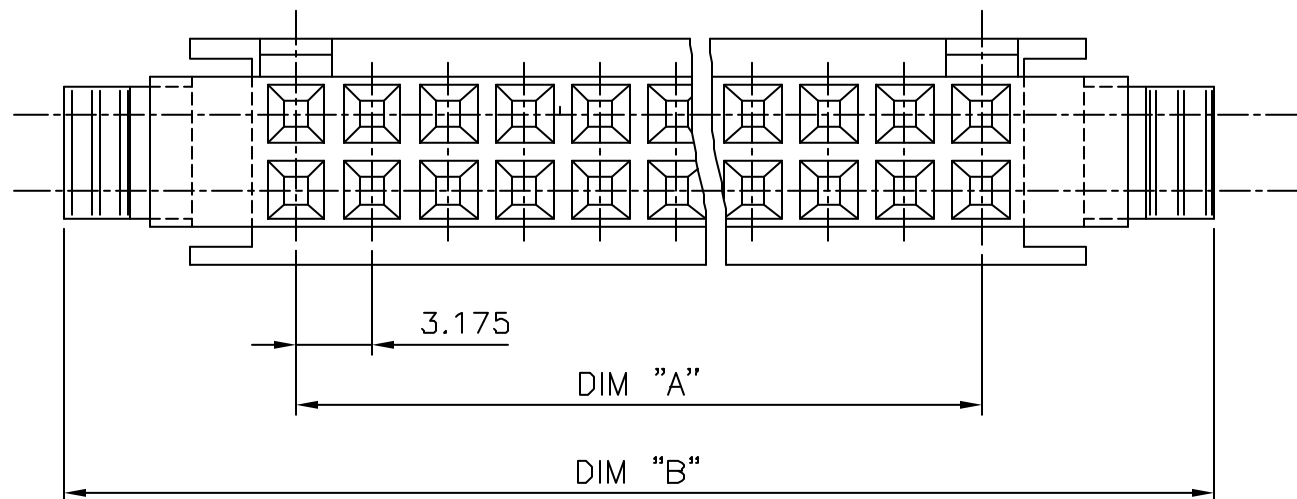
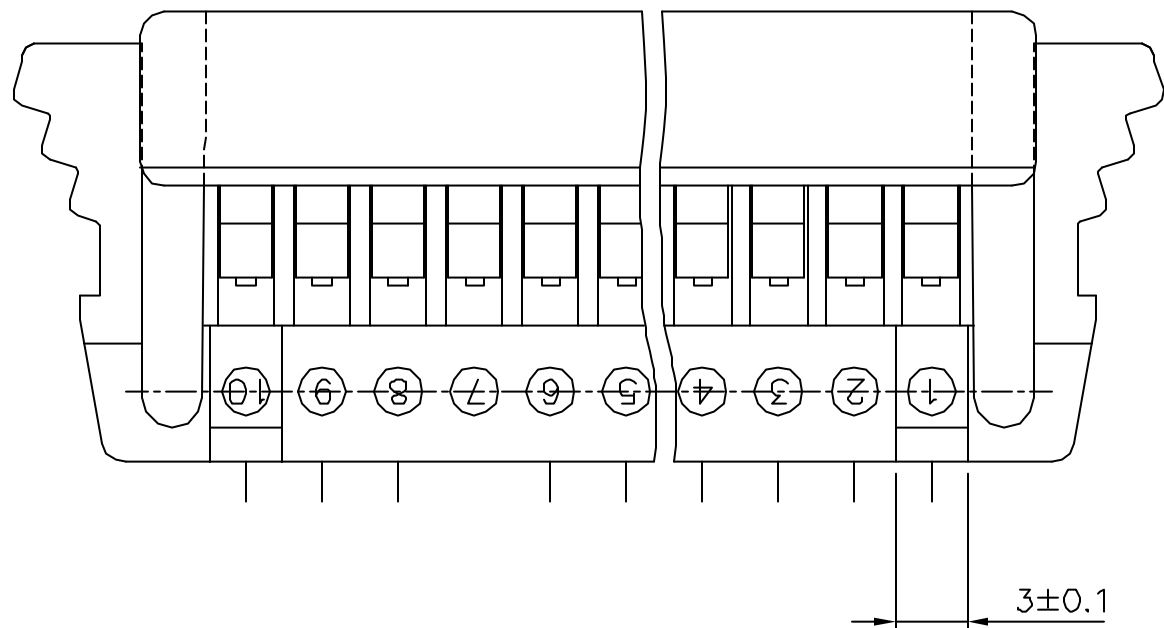

NOTES:

- 1 - PLASTIC MATERIAL: POLYAMID 25% GLASSFILLED , COLOR BLACK
FLAME RETARDANT PER UL 94-V0.
 - 2 - THIS HOUSING TO BE USED IN COMBINATION WITH BERG MAXI
PV TERMINAL ACCORDING TO CRIMPING METHODS DESCRIBED ON
DWG 65258 215 SHEET 1/1.
 - 3 - THIS CONNECTOR TO BE MATE WITH BERG HEADER 76427-YXX
OR 77432-YXX
 - 4 - RoHS COMPATIBLE PRODUCT SPECIFICATIONS
 - a - LABELING:
 - MEETS PACKAGING SPECS AS PER GS-14-920
 - b - LEGAL STATEMENT: SEE GS-22-008
- THE PRODUCT IS NOT INTENDED TO BE EXPOSED TO A
MANUFACTURING SOLDER PROCESS.

| | | | | | | | | | | |
|---------------------------|----------|-----|----------|---------------------------------------|----------------------|-------------------|--|--|--|--|
| mat'l. code SEE NOTE 1 | | | | surface ISO 1302 | tolerance ISO 406 | projection 101 | product family BERGCON | | | |
| ltr | ecn no | dr | date | tolerances unless otherwise specified | | mm | title POLARIZED MAXI LATCH HOUSING | | | |
| D | BNL5909 | AOO | 84.12.03 | angles | linear | | | | | |
| E | F60696 | JMC | 96.10.04 | | | scale 3:1 | dwg no 65258 | | | |
| F | F05-0235 | DLE | 05.08.24 | | | | | | | |
| G | F05-0286 | DLE | 05.11.07 | dr | COMPAGNON J | 96.02.08 | sheet 1 of 1 | | | |
| H | F06-0218 | DLE | 06.07.11 | enr | JMC | 96.02.08 | | | | |
| | | | | chr | | | size A3 | | | |
| | | | | appd | JMC | 96.02.08 | | | | |
| sheet | revision | | | | | | type CUSTOMER Drawing | | | |
| index | sheet | | | | | | | | | |

Mouser Electronics

Authorized Distributor

Click to View Pricing, Inventory, Delivery & Lifecycle Information:

[FCI / Amphenol:](#)

[65258-002LF](#) [65258-003LF](#) [65258-004LF](#) [65258-005LF](#) [65258-001LF](#)