

R1

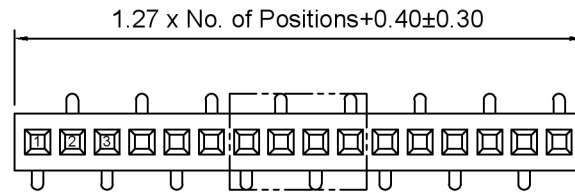

R2

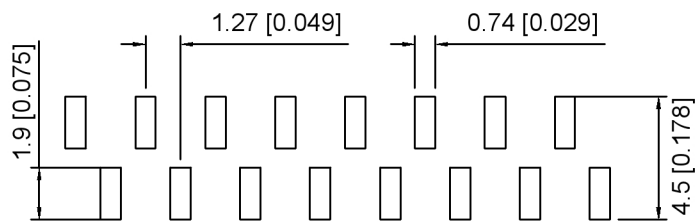
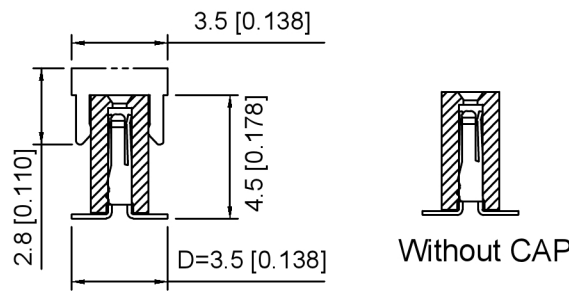
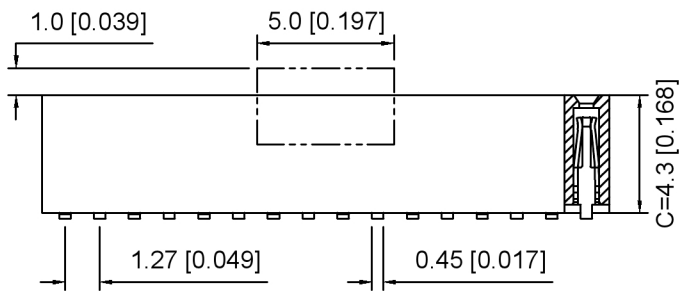

PCB LAYOUT (R1)

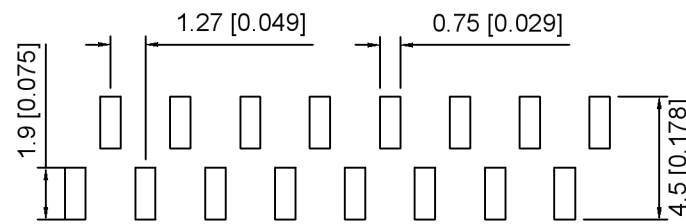

PCB LAYOUT (R2)

**Specifications:**  
**规格:**  
**Voltage rating:**250V AC/DC  
**额定电压:** 250V AC/DC  
**Current rating:**1A AC/DC  
**额定电流:** 1A AC/DC  
**Withstanding voltage:**300V AC/minute  
**耐受电压:** 300V AC/分钟  
**Temperature range:**-40℃~+105℃  
**温度范围:** -40℃~+105℃  
**Insulation resistance:**≥500MΩ  
**绝缘电阻:** ≥500MΩ  
**Contact resistance:**≤20mΩ  
**接触电阻:** ≤20mΩ  
**Material:**PA6T UL94V-0  
**材质:** PA6T UL94V-0  
**Plating Category:**1U"Gold  
**镀层:** 1U"Gold  
**Reflow soldering temperature:**260±5℃, 10S  
**回流焊温度:** 260±5℃, 10S

X1311 F V S - XX - C43 D35 X  
 ① ② ③ ④ ⑤ ⑥ ⑦ ⑧

1. Series No
2. Category: F-Female
3. Welding Board Angle: V-Stright 180°
4. Welding Way: S-SMT
5. Row No. Pin No: XX-01~40Pin
6. Plastic Height: C=4.3mm
7. Pin pitch: D=3.5mm
8. Type: R1 ; R2

X1311FVS-XX-C43D35X	PA6T	Brass	X1311W
PART NO	Material	Material(Pin)	Suitable XKB Wafer

广东星坤科技股份有限公司  
 文件工程章

ANGLAR	±5°
L ≤ 4	±0.2
4 < L ≤ 16	±0.3
16 < L ≤ 63	±0.4
L > 63	±0.5
UNSPECIFIED TOLERANCES	



DSND	SCALE: N/A	MODEL TYPE:	1.27mm BTB Connector
DWN	VIEW:	PART NO.:	X1311FVS-XX-C43D35X
CHKD	UNIT: mm/in	DWG NO.:	X-X1311FVS-XX-C43D35X
APPD	SIZE: A4	WEIGHT	SHEET
		1/1	REVISION
			A0