



ANATECH ELECTRONICS INC
RF & Microwave Filters & Products

19000 MHz Suspended Stripline Low Pass Filter

Part Number: AE19000SSL1026



Electrical Specifications

Cut Off Frequency: 19GHz
Pass Band Frequency: DC~19GHz
Pass Band Insertion Loss:
 $\leq 1.0\text{dB @ DC}\sim 18.2\text{GHz}$
 $\leq 3.0\text{dB @ } 18.2\sim 19\text{GHz}$
Pass Band VSWR: $\leq 1.6:1$
Stop Band Attenuation: $\geq 50\text{dB @ } 20.1\sim 26\text{GHz}$
Impedance: 50 Ohms
Power Handling: $\leq 15\text{W}$

Mechanical

Mounting Method: Through Holes
Connector Type: SMA-Female
Dimensions: 17 x 17 x 10 mm

Environmental

Operating Temperature: -45° to $+85^\circ$ C
Storage Temperature: -55° to $+95^\circ$ C
Shock: 20 G. 11ms
Vibration: 20 G. 5 to 200 Hz

Outline Drawing:

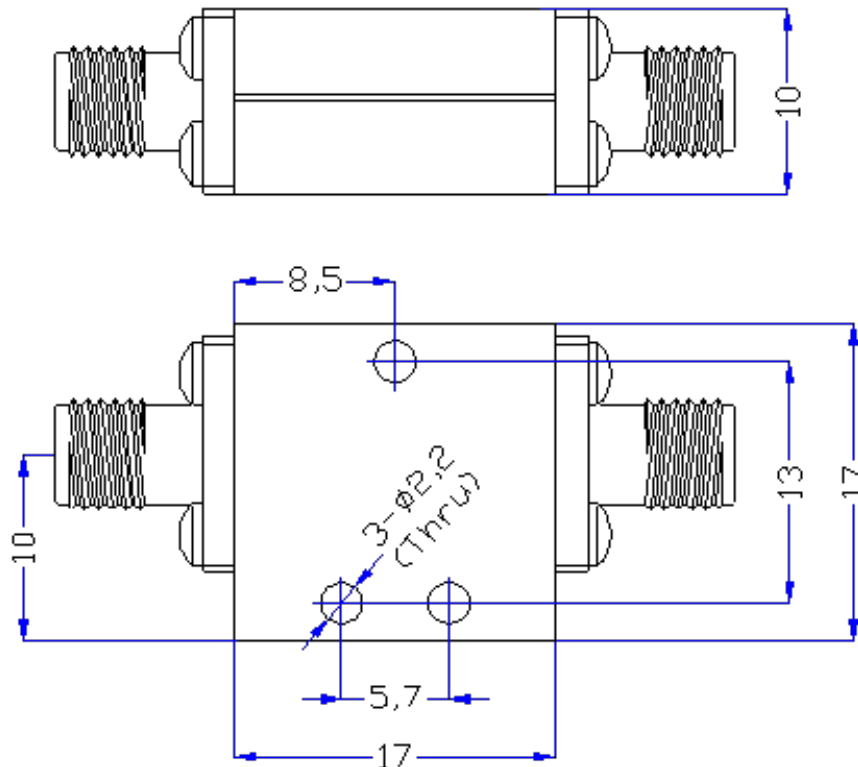

2 decimal places: ± 0.01 inches [$\pm 0.3\text{mm}$]
 3 decimal places: ± 0.005 inches [$\pm 0.13\text{mm}$]
 Angles: ± 1 Deg.

When max dimensions are called out the above tolerances do not apply as long as it is under the max call out.

70 Outwater Lane Phone: (973) 772-4242
Garfield, NJ 07026 Fax : (973) 321-3941

Email: sales@anatechelectronics.com
Web: www.anatechelectronics.com



19000 MHz Suspended Stripline Low Pass Filter

Part Number: AE19000SSL1026



Response plot:

