

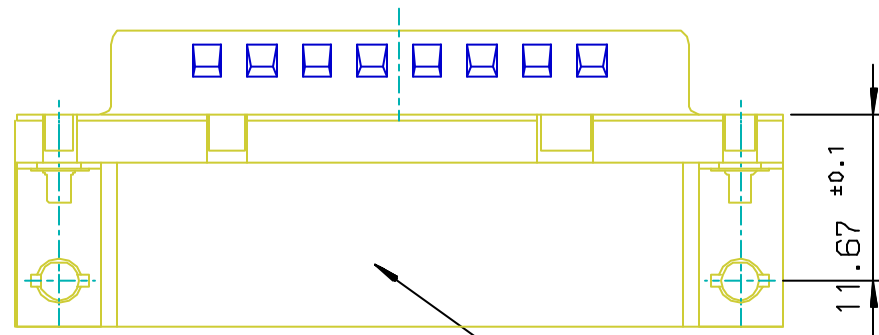

Copyright FCI.

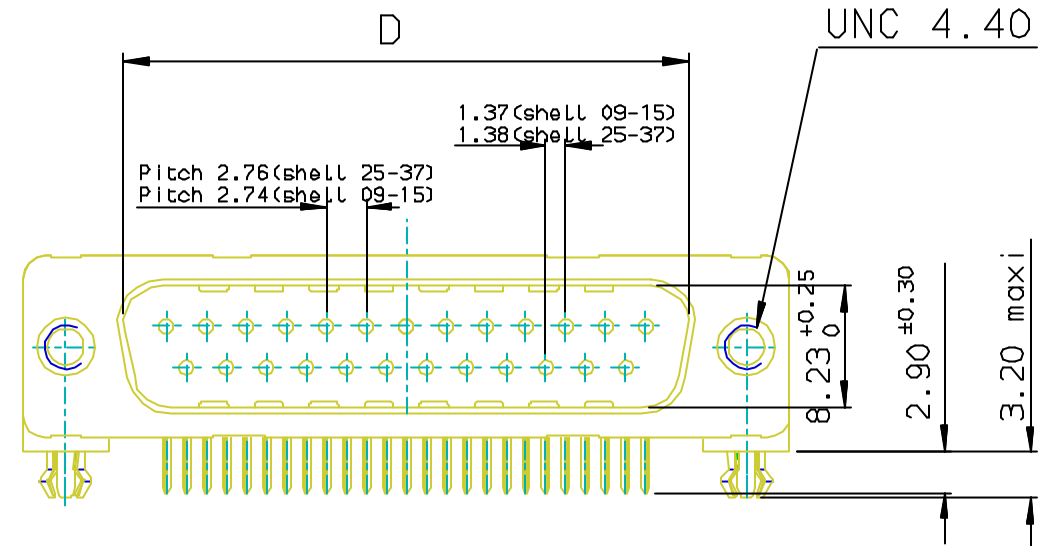
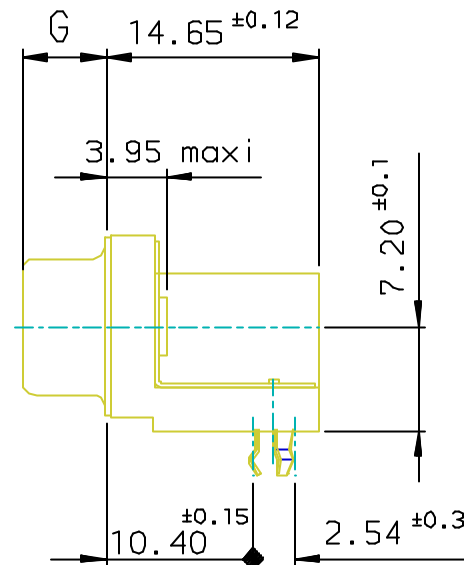
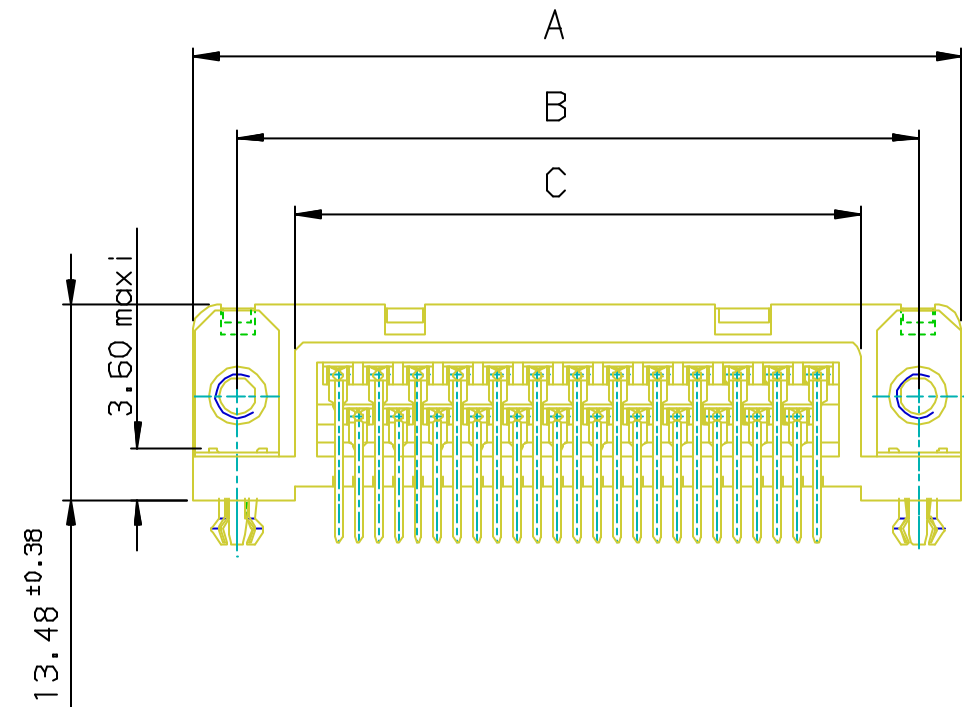

Part Number & Date Code Printing

PC card drilling dimensions(after plating)
(thickness 1.60±0.20mm)

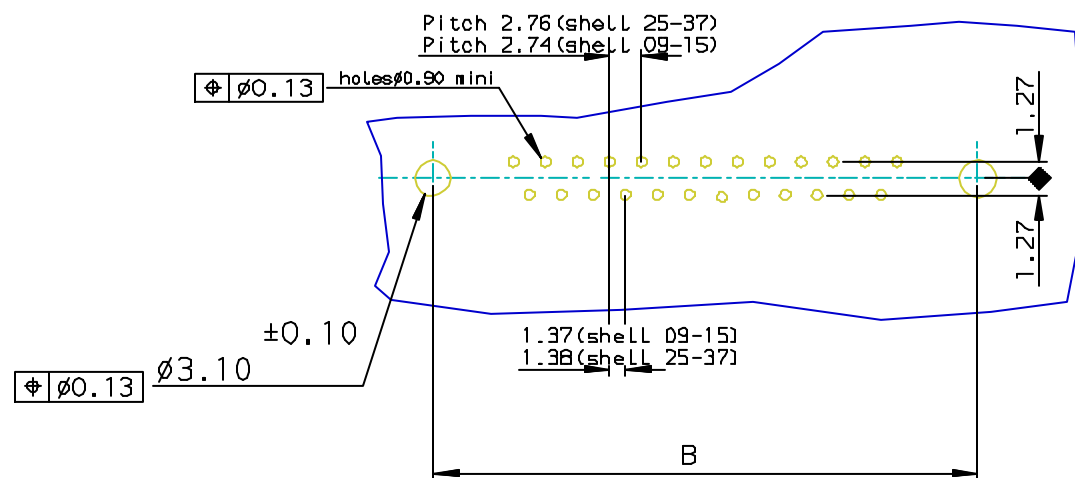

SHELL	A±0.38	B±0.12	C±0.10	D±0.25	G±0.25	PART NUMBER		
09	30.81	24.99	16.96	16.79	5.90	--	D09P13A6GX00**	D09P13A8GX00**
15	39.14	33.32	25.18	25.12	5.90	--	D15P13A6GX00**	D15P13A8GX00**
25	53.03	47.04	39.12	38.84	5.70	--	D25P13A6GX00**	D25P13A8GX00**
37	69.32	63.50	55.68	55.30	5.70	D37P13A4GX00**	D37P13A6GX00**	D37P13A8GX00**

GENERAL CHARACTERISTICS - SEE DRAWING C01-8646-0000

LF FOR LEAD FREE

European Views

www.fciconnect.com			surface ISO 1302	tolerance std ISO 406 ISO 1101	projection mm	size A3		Scale 1:1
			TOLERANCES UNLESS OTHERWISE SPECIFIED					
Dr	JOHN SLEEBA	1994/08/01	ANGULAR LINEAR	0.X	±0.1			
Eng	GEORGE VJ	1994/08/01		0.XX	±0.1			
Chr	GEORGE VJ	2005/07/27		0.XXX	±0.1			
Appr	KVSD	2005/07/27	Product family		D-SUB	Spec ref		-
			title			MALE CONNECT.DELTA D RIGHT ANGLED WITH NUT, HARPOON & METAL PLATE.	Rev.	C
			catalog no			DELTA-D	sheet 1 of 1	

rev	ecn no	dr	date
B	105-0124	JS	2005/07/27
C	106-0074	SK	2006/06/08
-	-	-	-
-	-	-	-
-	-	-	-
-	-	-	-

REV F - 2006-04-17

Mouser Electronics

Authorized Distributor

Click to View Pricing, Inventory, Delivery & Lifecycle Information:

[FCI / Amphenol:](#)

[D09P13A6GX00LF](#) [D15P13A6GX00LF](#) [D25P13A6GX00LF](#) [D37P13A4GX00LF](#) [D37P13A6GX00LF](#)