

1

2

3

4

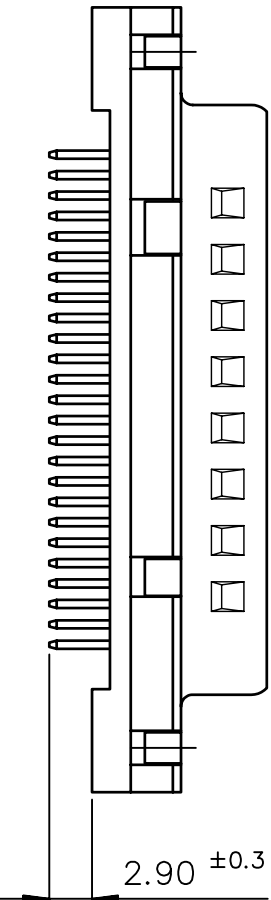
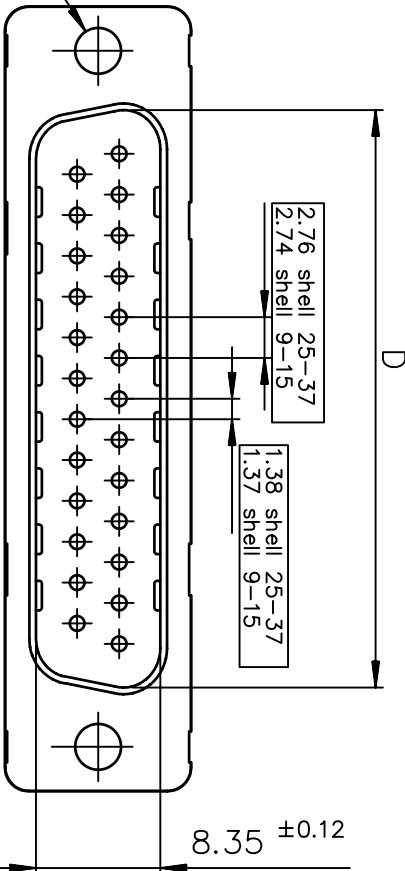
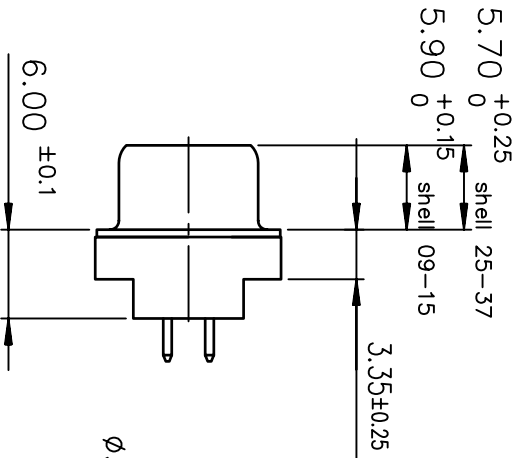
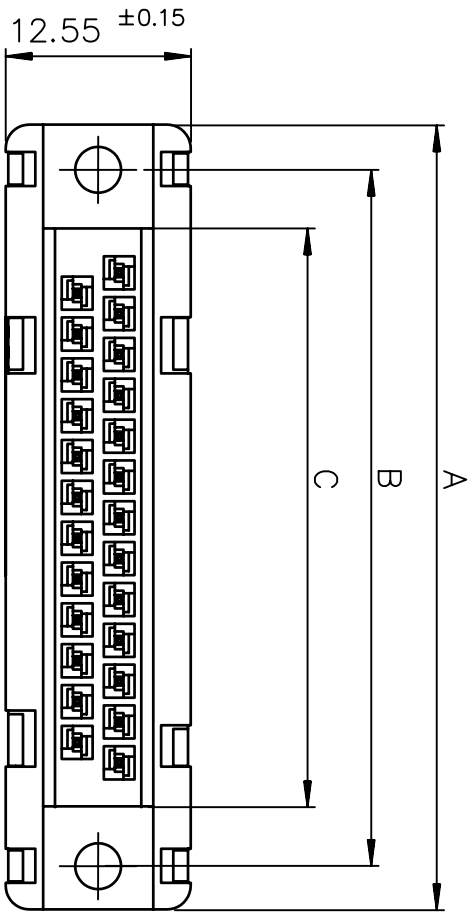

PC card drilling dimensions(after plating)  
(thickness 1.60±0.20mm)

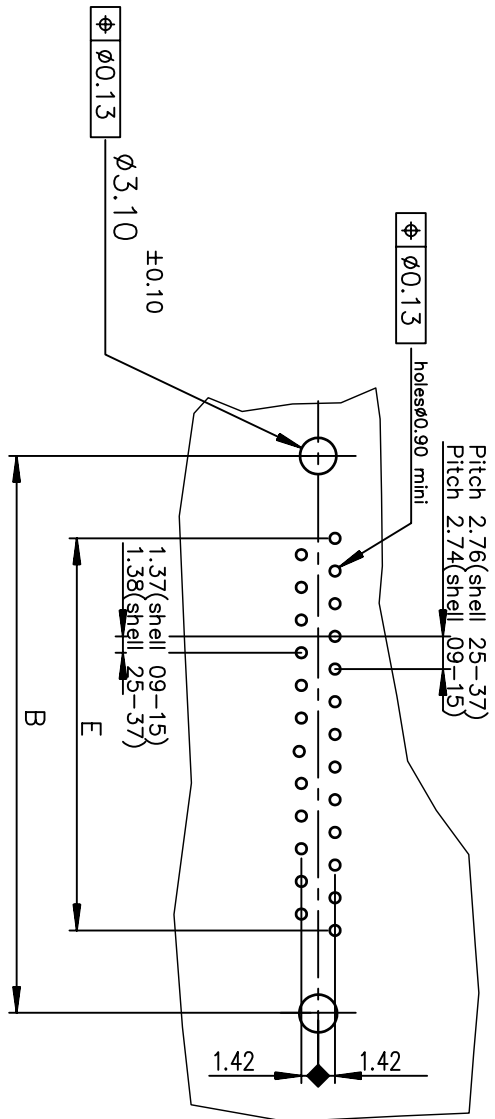

SECTION TERMINAISON CONTACT

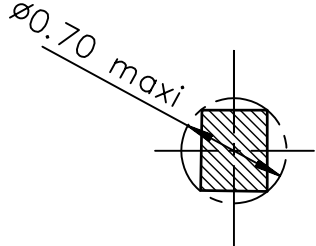

TIN LEAD PART NUMBER

SHELL	A±0.38	B±0.12	C±0.10	D±0.25	E±0.07	PART NUMBER
09	30.81	24.99	16.96	16.79	10.96	D09P24A.PA00
15	39.14	33.32	25.18	25.12	19.18	D15P24A.PA00
25	53.03	47.04	39.12	38.84	33.12	D25P24A.PA00
37	69.32	63.50	55.68	55.30	49.68	D37P24A.PA00

Plating: 4 --> flash AU  
Plating: 6 --> 0.76» AU

LEAD FREE PART NUMBER

SHELL	A±0.38	B±0.12	C±0.10	D±0.25	E±0.07	PART NUMBER
09	30.81	24.99	16.96	16.79	10.96	D09P24A.PA00LF
15	39.14	33.32	25.18	25.12	19.18	D15P24A.PA00LF
25	53.03	47.04	39.12	38.84	33.12	D25P24A.PA00LF
37	69.32	63.50	55.68	55.30	49.68	D37P24A.PA00LF

Plating: 4 --> flash AU  
Plating: 6 --> 0.76» AU

GENERAL CHARACTERISTICS AND ROHS INFORMATIONS:

SEE DRAWING C01-8646-0000

European Views

www.fciconnect.com		surface	ISO 1302	tolerance std	ISO 406 ISO 1101	projection	mm	Scale
		TOLERANCES UNLESS OTHERWISE SPECIFIED						2
Dr	JARRY	1992-09-11	ANGULAR	0.X		±0.1	size	
Eng	PESSON	1992-09-11	LINEAR	0.XX		±0.1	A3	
Chr	NIRMAL GEORGE	2009-11-24	0.XX' ±2"	0.XXX		±0.1	ECN	109-0268
Appr	SUDHIR VARMA	2009-11-24	Product family		D-SUB		Spec ref	-
FCI		MALE CONNECTOR DELTA D STD EUROPE		straight,solder type for PCB 1.6mm		C01-8646-0095		Rev.
catalog no				-		CUSTOMER		sheet 1 of 1



Copyright FCI.

# Mouser Electronics

Authorized Distributor

Click to View Pricing, Inventory, Delivery & Lifecycle Information:

[FCI / Amphenol:](#)

[D09P24A4PA00LF](#) [D09P24A6PA00LF](#) [D15P24A4PA00LF](#) [D15P24A6PA00LF](#) [D25P24A6PA00LF](#)  
[D37P24A4PA00LF](#) [D37P24A6PA00LF](#) [D25P24A4PA00LF](#)