

PCB Layout (Pattern Side)

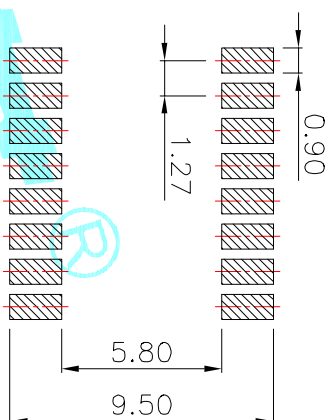

NOTE:

1. Rating: 24V 25mA DC
2. Insulation Resistance: $\geq 100 \text{ M}\Omega$
3. Withstand voltage: AC 500V 1Minute
4. Operating Force Range: 800gf Max
5. Mechanical Life: 3,000 Cycles
6. Operating Temperature range $-20^{\circ}\sim +70^{\circ}\text{C}$
7. Ambient Humidity used: $\leq 85\% \text{RH}$

Position(位数)	2P	4P	6P	8P	10P	
DIM.A(长度)	4.07	6.61	9.15	11.69	14.23	
DIM.B(长度)	1.27	3.81	6.35	8.89	11.43	
PART NO. 型号/颜色(K)	短柄(S)	EP-02KS	EP-04KS	EP-06KS	EP-08KS	EP-10KS

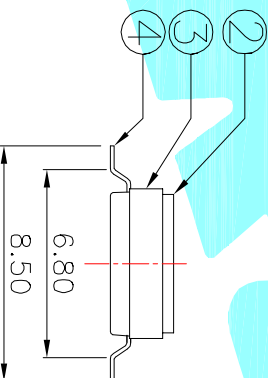

ECN NO.	REV.	DATE.	DESCRIPTION.	CHANGE.	CHECK.	APPRO.
	A		NEW			
<p>APPROVALS</p> <p>CHECKED</p> <p>DRAWN J.X.Zhong 2014/08/20</p> <p>TOLERANCES ARE 30~100μ ±0.30 ANGLE ±2° UNIT: mm SCALE: 1:1</p>						
APPROVALS			PART NO. EP-0000			
TITLE: MULTIFUNCTIONAL SWITCHES			PROJ: 1 OF 1			
DRAWN J.X.Zhong 2014/08/20			SHEET 1 OF 1			
DATE			REMARK			
TER'NO. QTY.			MATERIAL FINISHING			
PART NAME			REMARK			
ITEM			REMARK			
⑤	Contact Spring	—	Phosphor bronze	Au Plating	—	—
④	Terminal	—	Phosphor bronze	Au Plating	—	—
③	Base	1	PBT	Black	—	—
②	Cover	1	PBT	Black	—	—
①	Keystroke	—	PBT	White	—	—



HROELECTRONICS CO., LTD