

THIS DOCUMENT IS SUBJECT TO CHANGE WITHOUT NOTICE. IT IS CONFIDENTIAL AND A PROPERTY OF AMPHENOL LTW. DISCLOSURE TO THIRD PARTY HAS TO BE AUTHORIZED BY AMPHENOL LTW.

REV.	ECN NO.	DATE	SIGN	DESCRIPTION
A	Initial Release	2013/09/06	Ruru	Old Item No. CAP-WAACFLBI
B	LEN1530068	2015/02/12	Ruru	Change Logo

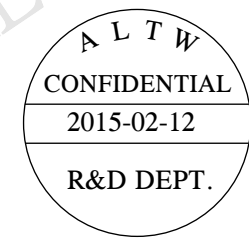
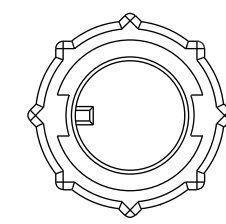
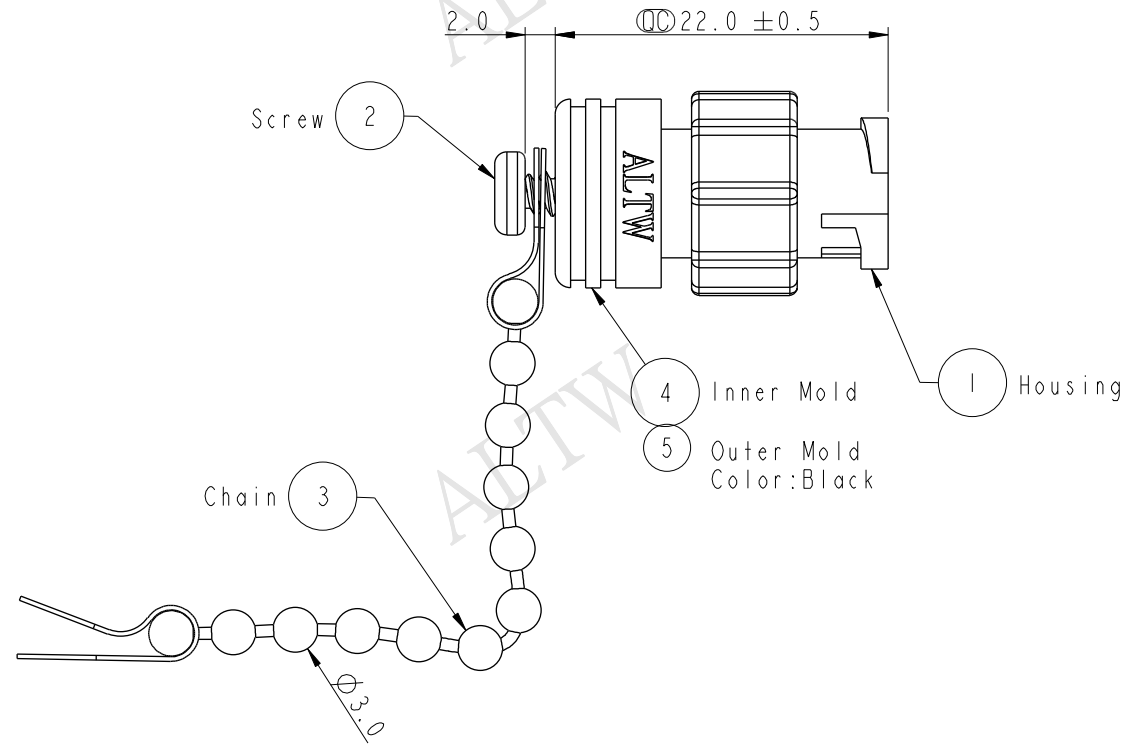
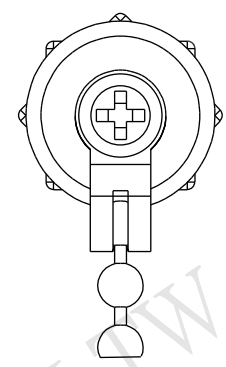

- Note:
- \*  $\varnothing$  Important Dimension To Check
  - \* Waterproof Rate: IP67
  - \* Housing: Nylon+GF, Black
  - \* Screw is not allowed to tight (Chain be revolve)  
不可將螺絲鎖緊，(鏈條要可旋轉)
  - \* Drill Hold  $\varnothing$ 2.3mm, Depth 4mm  
鑽孔 $\varnothing$ 2.3mm, 深4mm

UNIT:mm		
TOLERANCE		
.X	$\pm 0.25$	
.XX	$\pm 0.1$	
.XXX	$\pm 0.05$	
ANGLES	$\pm 1^\circ$	

TITLE Mini Size Waterproof Cap for F Conn F Pin			
SCALE 1:1	SIZE A4	SHEET 1 OF 1	
REV. B	WC-REV. A.4	$\varnothing$ : Inspection item	

**Amphenol LTW**  
安費諾亮泰企業股份有限公司

ITEM NO. CAP-WAAFLPBI	DRAWN BY Ruru	DATE 2015-02-12
DWG NO. CAP-WAAFLPBI	CHECKED BY Rita	DATE 2015-02-12
CUSTOMER ALTW	APPROVED BY Lion	DATE 2015-02-12

ALTW