

THIS DOCUMENT IS SUBJECT TO CHANGE WITHOUT NOTICE. IT IS CONFIDENTIAL AND A PROPERTY OF AMPHENOL LTW. DISCLOSURE TO THIRD PARTY HAS TO BE AUTHORIZED BY AMPHENOL LTW.

REV.	ECN NO.	DATE	SIGN	DESCRIPTION
A		2021-08-27	Allen Pan	Rev.03 To Rev.A

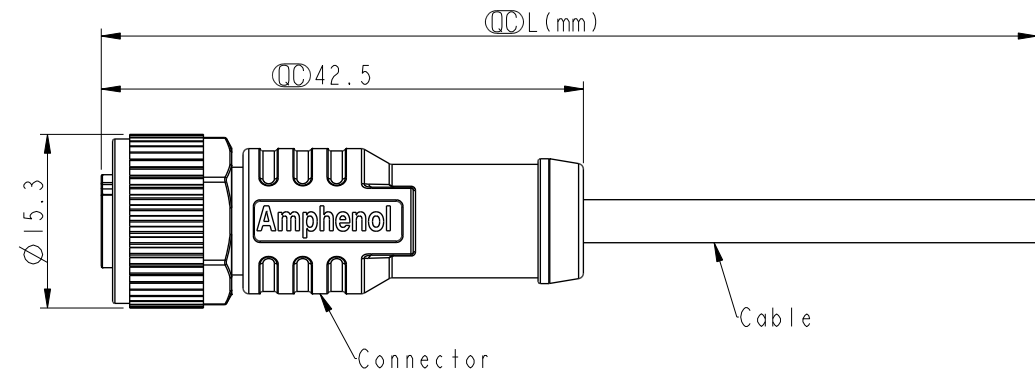

M12A-XXBFFM-SL8CXX

XX: No. Of Pin

XX: 01~15Meters
 01: 01Meter
 02: 02Meters
 ...
 15: 15Meters

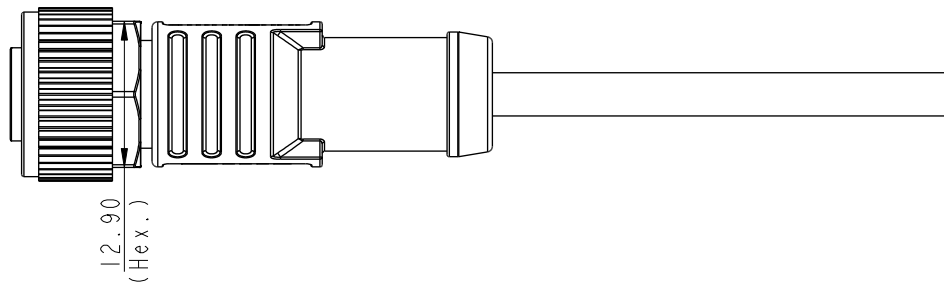
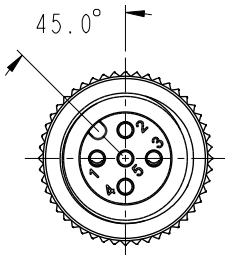

- Note:
- * RoHS Compliant
 - * \varnothing Important dimension
 - * Waterproof rate: IPX8, mated 1m/24h
IPX9K, mated
 - * Connector
 - Housing: Thermoplastic, Black
 - Pin: Copper alloy, Gold plated
 - O-Ring: Rubber, Green
 - Nut: Metal
 - Outer mold: Thermoplastic, Black
 - * Cable: IEC61156-12, 26#*IP+AL/MY+B, OD=3.8mm, PUR Jacket, Green
 - * Cable length tolerance: 1M: +50/-0 mm
 - 1M < L ≤ 3M: +100/-0 mm
 - 3M < L ≤ 5M: +150/-0 mm
 - 5M < L ≤ 10M: ±100 mm
 - 10M < L ≤ 15M: ±200 mm

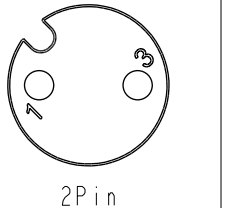

3	White	白
1	Blue	藍
Pin#	Wire	

Pin Assignments
Front View

UNIT:mm

TOLERANCE

±0.5mm

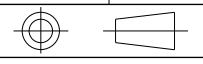

TITLE			
N SEN, M12 A, SCREW CABLE W/O SR, F, F, MOLDING			
SCALE	SIZE	SHEET	OF
3:2	A4	1	1
REV.	WC-REV.	\varnothing : Inspection item	
A	A.1		

Amphenol LTW

安費諾亮泰企業股份有限公司

ITEM NO	DRAWN BY	DATE
	Allen Pan	2021-08-27
DWG NO	CHECKED BY	DATE
M12A-XXBFFM-SL8CXX	Sam Ho	2021-08-27
CUSTOMER	APPROVED BY	DATE
ALTW	Fred Lee	2021-08-27